

## **EXHIBIT A**

### **100% FINAL Design Drawings\_Civil\_Iron Gate (Dec2022) (CEII)**

#### **CRITICAL ENERGY/ELECTRIC INFRASTRUCTURE INFORMATION (CEII)**

#### **FOLLOWING DRAWINGS REDACTED IN ENTIRETY**

**C4050, C4051, C4052, C4055, C4100, C4108, C4120, C4121, C4122, C4123, C4124, C4125, C4130, C4131, C4132, C4133, C4170, C4175, C4176, C4190, C4191, C4192, C4193, C4194, C4195, C4196, C4200, C4201, C4203, C4204, C4205, C4206, C4207, C4208, C4209, C4230, C4231, C4235, C4236, 4237, C4238, C4239, C4250, C4255, C4300, C4301, C4405, C4500, C4510, C4515, C4520, C4521, C4600, C4601, C4605, C4615**

The redacted material qualifies as CEII pursuant to the Commission's rules because it contains sensitive dam safety and construction information that (a) relates details about the production, generation, transmission, or distribution of energy, (b) could be useful to a person planning an attack on critical infrastructure, (c) is exempt from mandatory disclosure under the Freedom of Information Act, and (d) gives strategic information beyond the location of the critical infrastructure. Accordingly, the Renewal Corporation has requested confidential treatment of this material pursuant to 18 C.F.R. § 388.113.



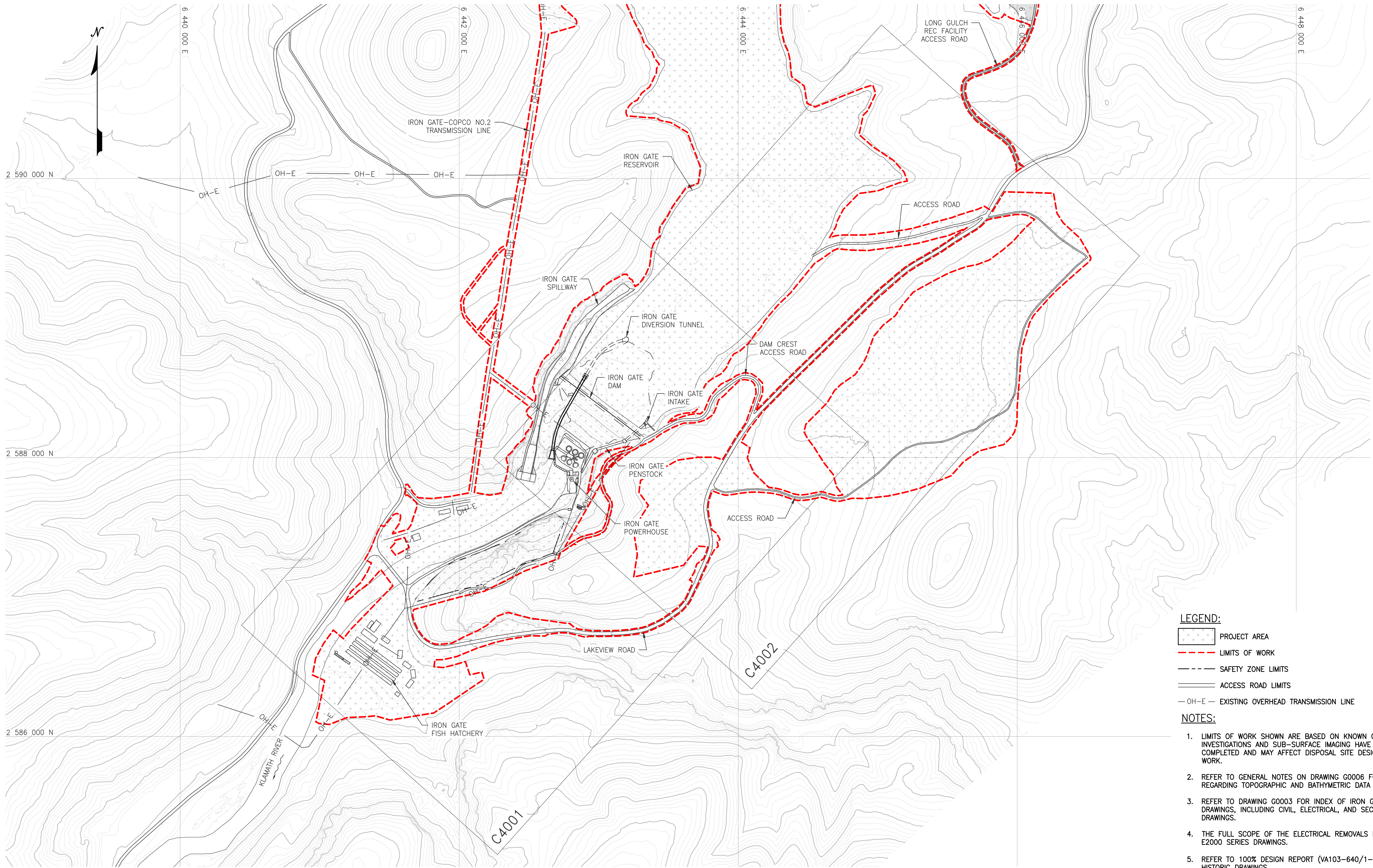

- LEGEND:**
- PROJECT AREA
  - LIMITS OF WORK
  - SAFETY ZONE LIMITS
  - ACCESS ROAD LIMITS
  - EXISTING OVERHEAD TRANSMISSION LINE

- NOTES:**
- LIMITS OF WORK SHOWN ARE BASED ON KNOWN CONDITIONS. SITE INVESTIGATIONS AND SUB-SURFACE IMAGING HAVE NOT BEEN COMPLETED AND MAY AFFECT DISPOSAL SITE DESIGN AND RESTORATION WORK.
  - REFER TO GENERAL NOTES ON DRAWING G0006 FOR INFORMATION REGARDING TOPOGRAPHIC AND BATHYMETRIC DATA SOURCES.
  - REFER TO DRAWING G0003 FOR INDEX OF IRON GATE FACILITY DRAWINGS, INCLUDING CIVIL, ELECTRICAL, AND SECURITY DISCIPLINE DRAWINGS.
  - THE FULL SCOPE OF THE ELECTRICAL REMOVALS IS SHOWN ON THE E2000 SERIES DRAWINGS.
  - REFER TO 100% DESIGN REPORT (VA103-640/1-9), APPENDIX K FOR HISTORIC DRAWINGS.

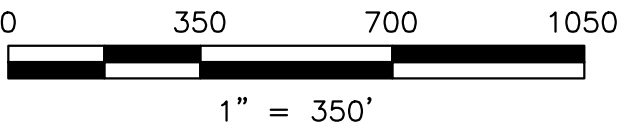

PLAN  
1" = 350'

ISSUED FOR CONSTRUCTION

egulavrra May 25, 2022 - 1:11pm  
NA11030064001\A\asad\DWGS\C4000\C4000.dwg

|     |                         |     |     |     |          |
|-----|-------------------------|-----|-----|-----|----------|
| 0   | ISSUED FOR CONSTRUCTION | KTW | HE  | SRM | 05/27/22 |
| REV | DESCRIPTION             | BY  | CHK | APP | DATE     |

WARNING  
0 1/2 1  
IF THIS BAR DOES NOT MEASURE 1" THEN DRAWING IS NOT TO SCALE



|           |                  |
|-----------|------------------|
| DESIGNED  | K. WECHSELBERGER |
| DRAWN     | R. McLELLAN      |
| REVIEWED  | H. ELWIN         |
| IN CHARGE | N. BISHOP        |
| APPROVED  | S. MOTTRAM       |



|             |  |  |        |             |
|-------------|--|--|--------|-------------|
| PROJECT     | KLAMATH RIVER RENEWAL PROJECT  |  | PROJ # | VA103-640/1 |
|             |  |  | DATE   | 05/27/2022  |
| SHEET TITLE | IRON GATE FACILITY<br>PROJECT OVERVIEW AND LIMITS OF WORK<br>KEY MAP |  | DWG    | C4000       |



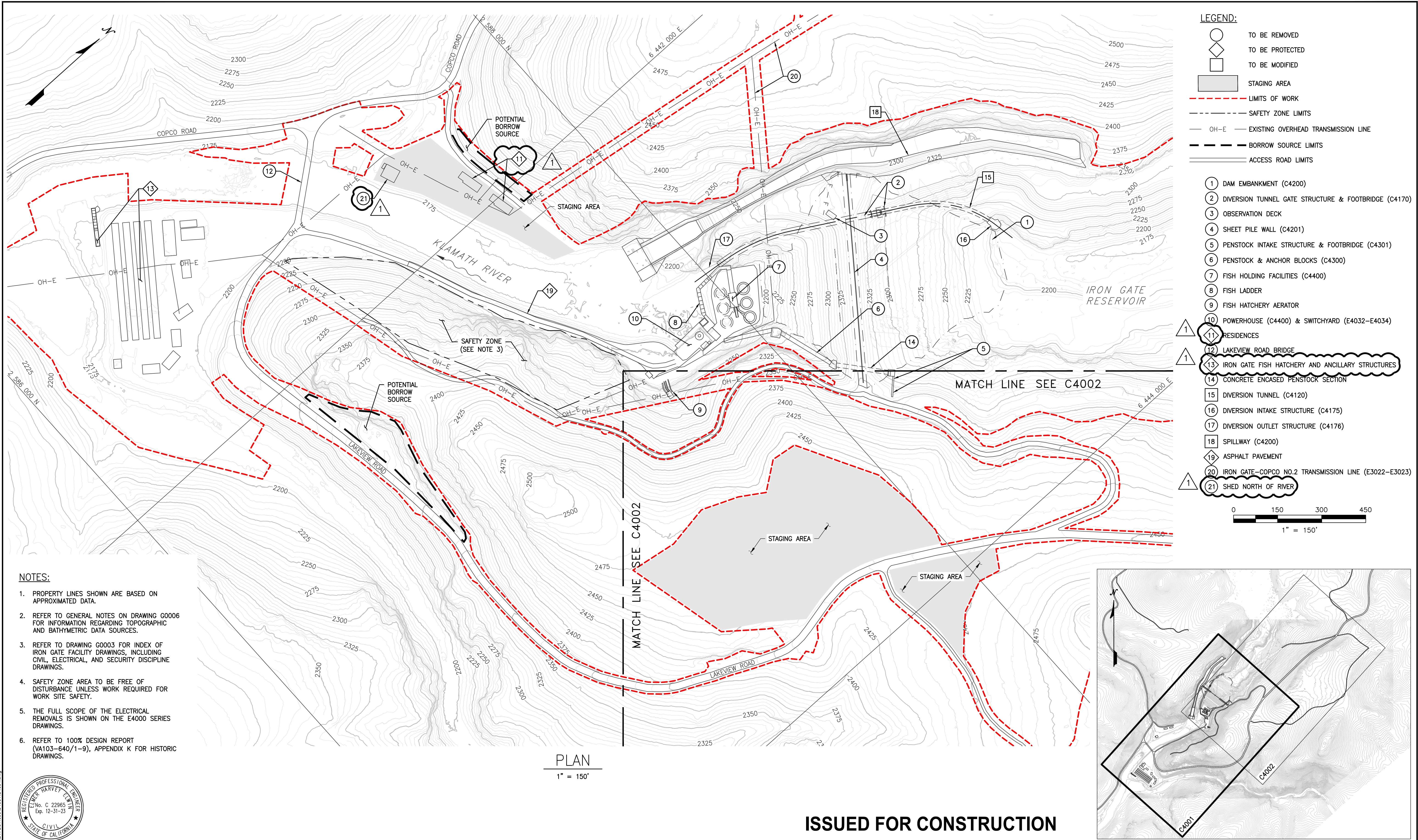

- NOTES:**
- PROPERTY LINES SHOWN ARE BASED ON APPROXIMATED DATA.
  - REFER TO GENERAL NOTES ON DRAWING G0006 FOR INFORMATION REGARDING TOPOGRAPHIC AND BATHYMETRIC DATA SOURCES.
  - REFER TO DRAWING G0003 FOR INDEX OF IRON GATE FACILITY DRAWINGS, INCLUDING CIVIL, ELECTRICAL, AND SECURITY DISCIPLINE DRAWINGS.
  - SAFETY ZONE AREA TO BE FREE OF DISTURBANCE UNLESS WORK REQUIRED FOR WORK SITE SAFETY.
  - THE FULL SCOPE OF THE ELECTRICAL REMOVALS IS SHOWN ON THE E4000 SERIES DRAWINGS.
  - REFER TO 100% DESIGN REPORT (VA103-640/1-9), APPENDIX K FOR HISTORIC DRAWINGS.



PLAN  
1" = 150'

ISSUED FOR CONSTRUCTION

|     |                          |     |     |     |          |  |  |  |  |  |   |  |   |  |   |  |  |
|-----|--------------------------|-----|-----|-----|----------|--|--|--|--|--|---|--|---|--|---|--|--|
|     |                          |     |     |     |          | <div>WARNING</div> <div>0 1/2 1</div> <div><div></div></div> |  |  | <div>PREPARED BY</div> <div><div><div></div></div> Knight Piésold<br/>CONSULTING</div> |  | <div>DESIGNED</div> <div>K. WECHSELBERGER</div> <div>DRAWN</div> <div>R. McLELLAN</div> <div>REVIEWED</div> <div>H. ELWIN</div> <div>IN CHARGE</div> <div>N. BISHOP</div> <div>APPROVED</div> <div>S. MOTTRAM</div> |  | <div>PREPARED FOR</div> <div><div><div></div></div> KLAMATH<br/>RIVER RENEWAL<br/>CORPORATION</div> |  | <div>PROJECT</div> <div>KLAMATH RIVER RENEWAL PROJECT</div> |  | <div>PROJ #</div> <div>VA103-640/1</div> |
|     |                          |     |     |     |          | IF THIS BAR DOES NOT MEASURE 1" THEN DRAWING IS NOT TO SCALE |  |  |  |  |   |  |   |  | <div>DATE</div> <div>05/27/2022</div>                       |  |  |
| 1   | BUILDING REMOVAL REVISED | KTW | HE  | SRM | 12/21/22 |  |  |  |  |  |   |  |   |  | <div>DWG</div> <div>C4001</div>                             |  |  |
| 0   | ISSUED FOR CONSTRUCTION  | KTW | HE  | SRM | 05/27/22 |  |  |  |  |  |   |  |   |  |   |  |  |
| REV | DESCRIPTION              | BY  | CHK | APP | DATE     |  |  |  |  |  |   |  |   |  |   |  |  |



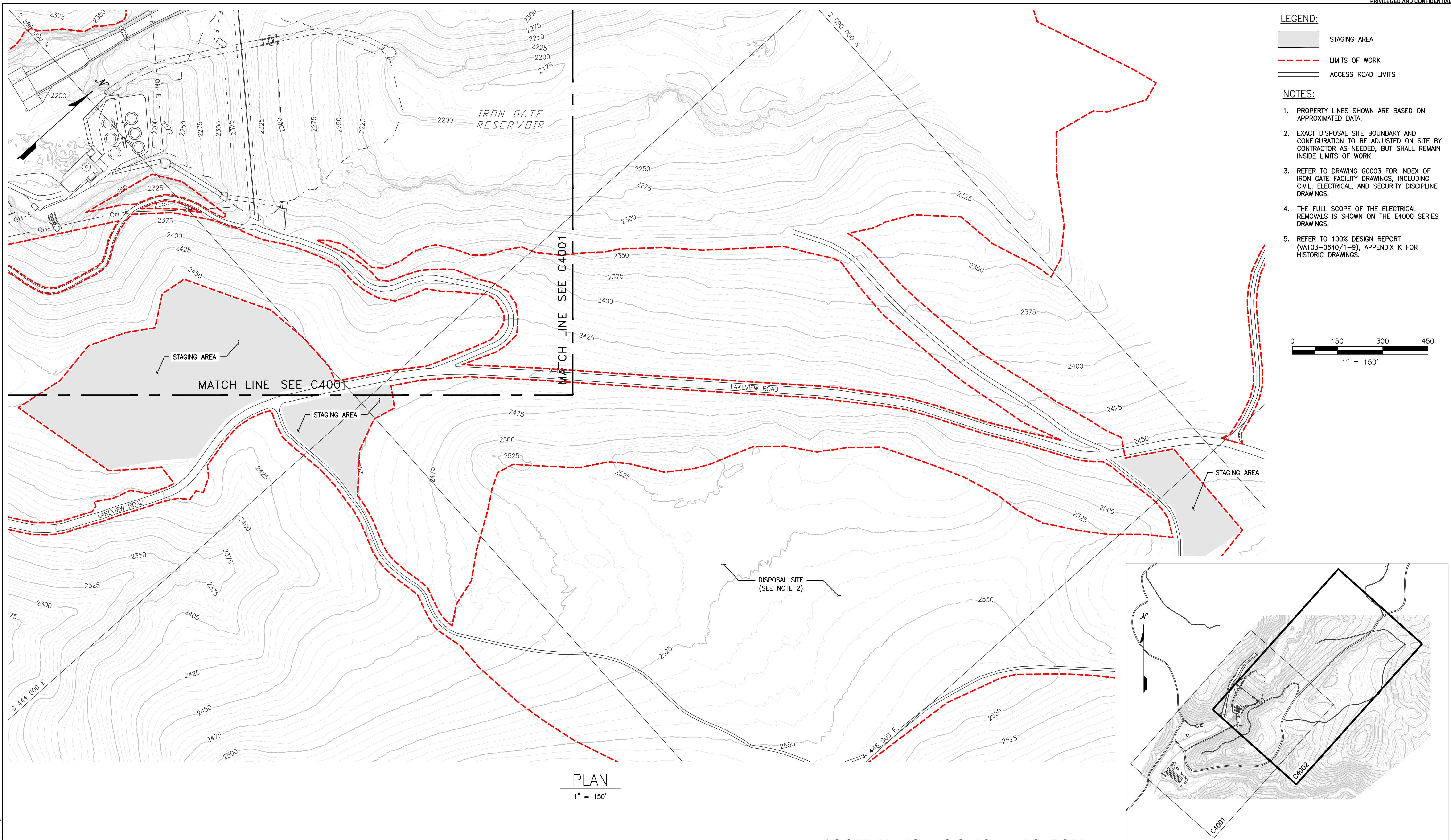

egulavrra\_May 25, 2022 - 11:22am  
NA11030064001\A\asad\DWGS\4000\C4002\C4002.dwg

| REV | DESCRIPTION             | BY  | CHK | APP | DATE     |
|-----|-------------------------|-----|-----|-----|----------|
| 0   | ISSUED FOR CONSTRUCTION | KTW | HE  | SRM | 05/27/22 |

WARNING  
0 1/2 1  
IF THIS BAR DOES NOT MEASURE 1" THEN DRAWING IS NOT TO SCALE



PREPARED BY  
**Knight Piésold CONSULTING**  
**Kiewit**

DESIGNED K. WECHSELBERGER  
DRAWN R. McLELLAN  
REVIEWED H. ELWIN  
IN CHARGE N. BISHOP  
APPROVED S. MOTTRAM

PREPARED FOR  
**KLAMATH RIVER RENEWAL CORPORATION**

|             |   |        |             |
|-------------|---|--------|-------------|
| PROJECT     | KLAMATH RIVER RENEWAL PROJECT   | PROJ # | VA103-640/1 |
| SHEET TITLE | IRON GATE FACILITY<br>PROJECT OVERVIEW AND LIMITS OF WORK<br>(SHEET 2 OF 2) | DATE   | 05/27/2022  |
| DWG         | C4002   |        |             |



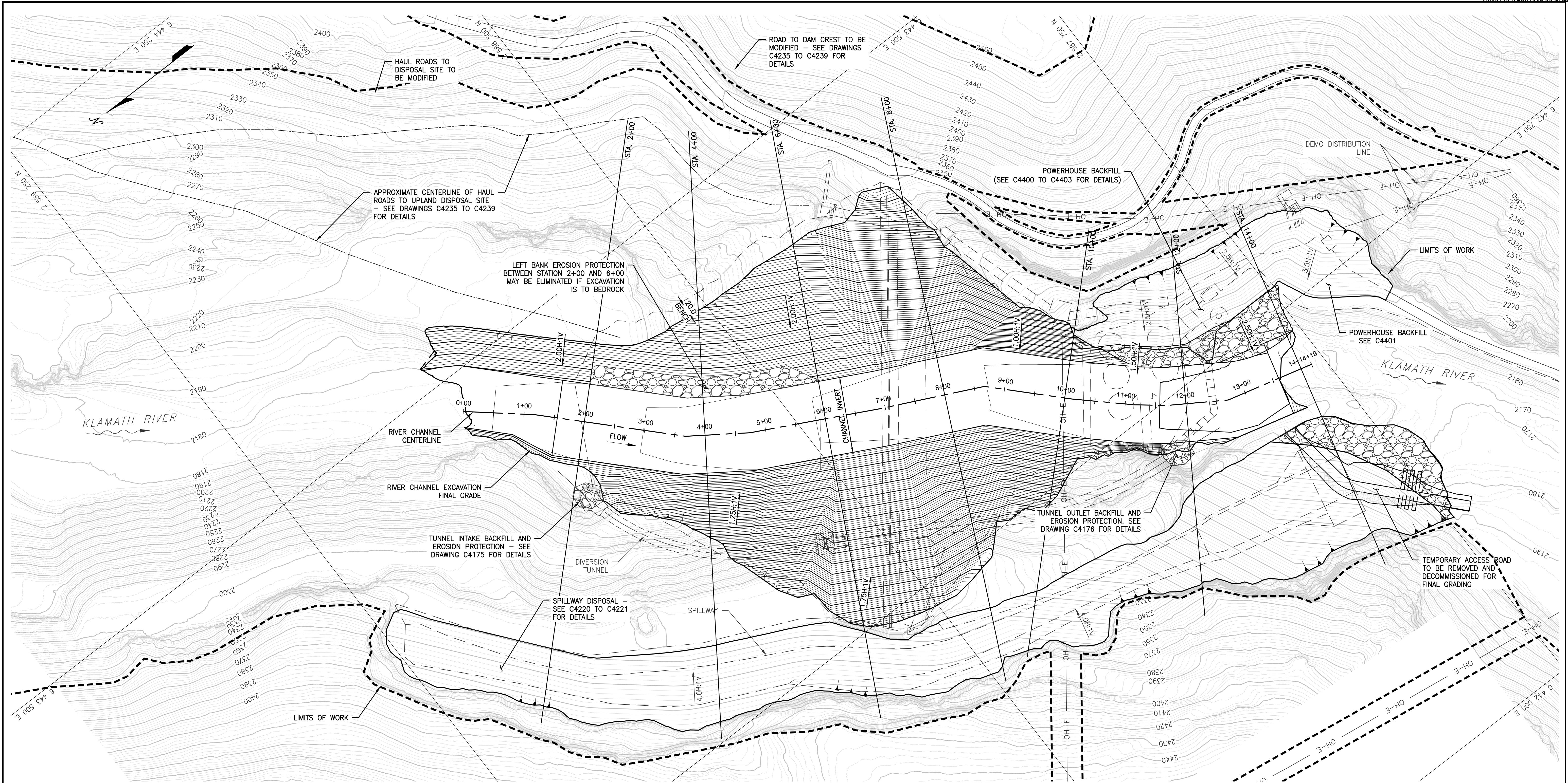

NOTES:

- REFER TO GENERAL NOTES ON G0006 FOR INFORMATION REGARDING TOPOGRAPHIC AND BATHYMETRIC DATA SOURCES.
- CONTOUR INTERVALS ARE 2 ft.
- ALL CORE ZONE MATERIAL (ZONE III) SHALL BE EXCAVATED TO BEDROCK. ALL OTHER EXCAVATED SURFACE SHALL BE TO BEDROCK OR EXCAVATION EXTENTS SHOWN HERE.
- FOR FINAL GRADE SURFACE TREATMENT, SEE DRAWING SERIES C4600.
- NO EROSION PROTECTION REQUIRED WHERE EXCAVATION IS TO BEDROCK.

- TOP OF RIPRAP SHALL PROVIDE 3 ft. OF FREEBOARD ON THE PROBABLE WATER SURFACE LEVEL AND SHALL APPROXIMATELY FOLLOW THE CHANNEL SLOPE.

PLAN

1" = 80'

ISSUED FOR CONSTRUCTION

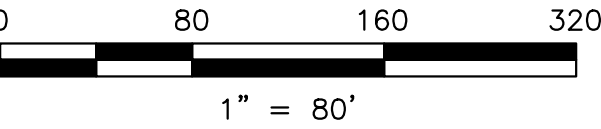

g:\projects\16-71\_2022\_4135m\16-71\_2022\_4135m.dwg  
03/08/2022 11:41:00 AM  
C:\Users\jyong\OneDrive\Documents\Klamath River Renewal\16-71\_2022\_4135m\16-71\_2022\_4135m.dwg

| REV | DESCRIPTION             | BY  | CHK | APP | DATE     |
|-----|-------------------------|-----|-----|-----|----------|
| 1   | ISSUED FOR CONSTRUCTION | KTW | SY  | SRM | 06/22/22 |
| 0   | ISSUED FOR CONSTRUCTION | KTW | SY  | SRM | 05/27/22 |

WARNING  
0 1/2 1  
IF THIS BAR DOES NOT MEASURE 1" THEN DRAWING IS NOT TO SCALE







|           |                  |
|-----------|------------------|
| DESIGNED  | K. WECHSELBERGER |
| DRAWN     | A. TSENG         |
| REVIEWED  | S. YONG          |
| IN CHARGE | N. BISHOP        |
| APPROVED  | S. MOTTRAM       |

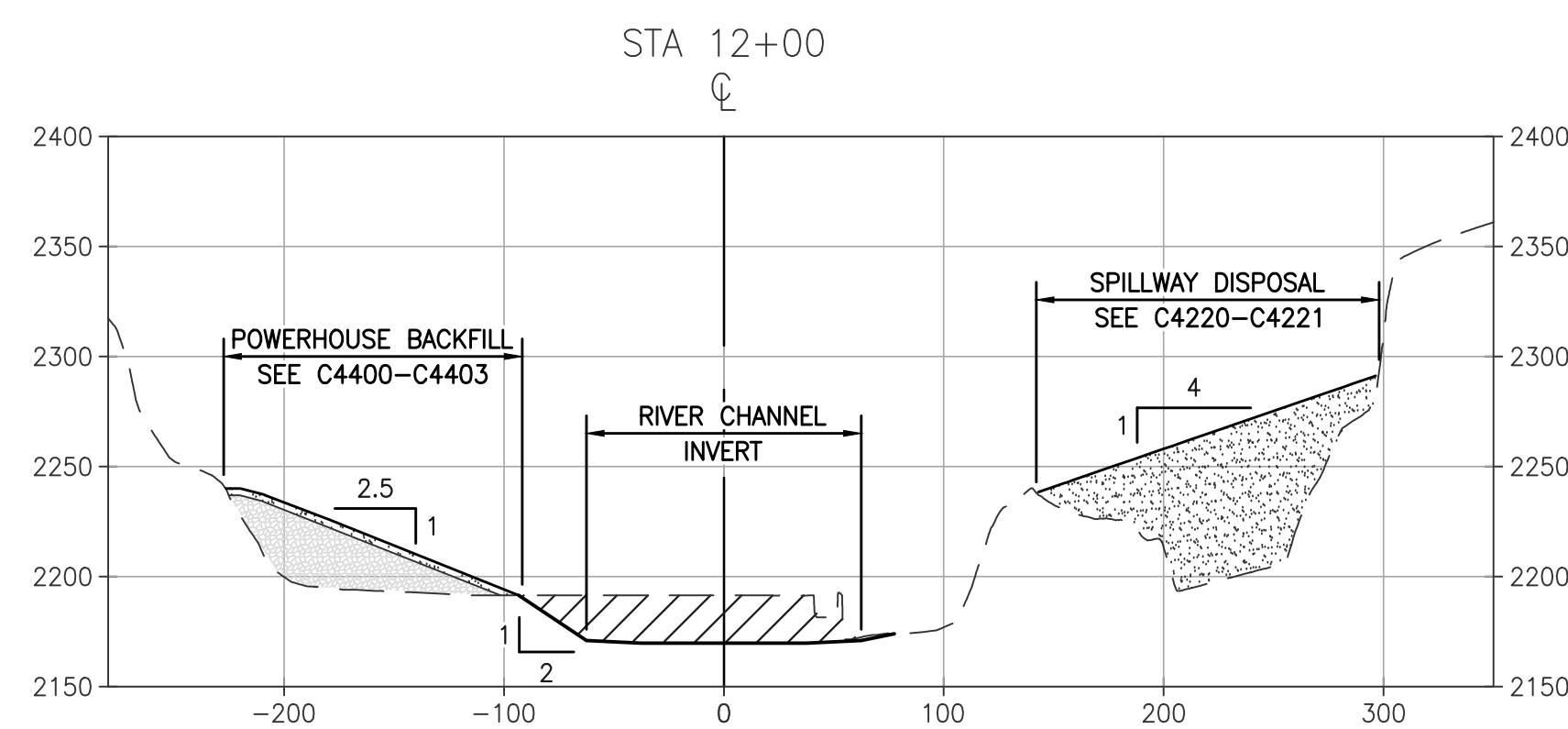
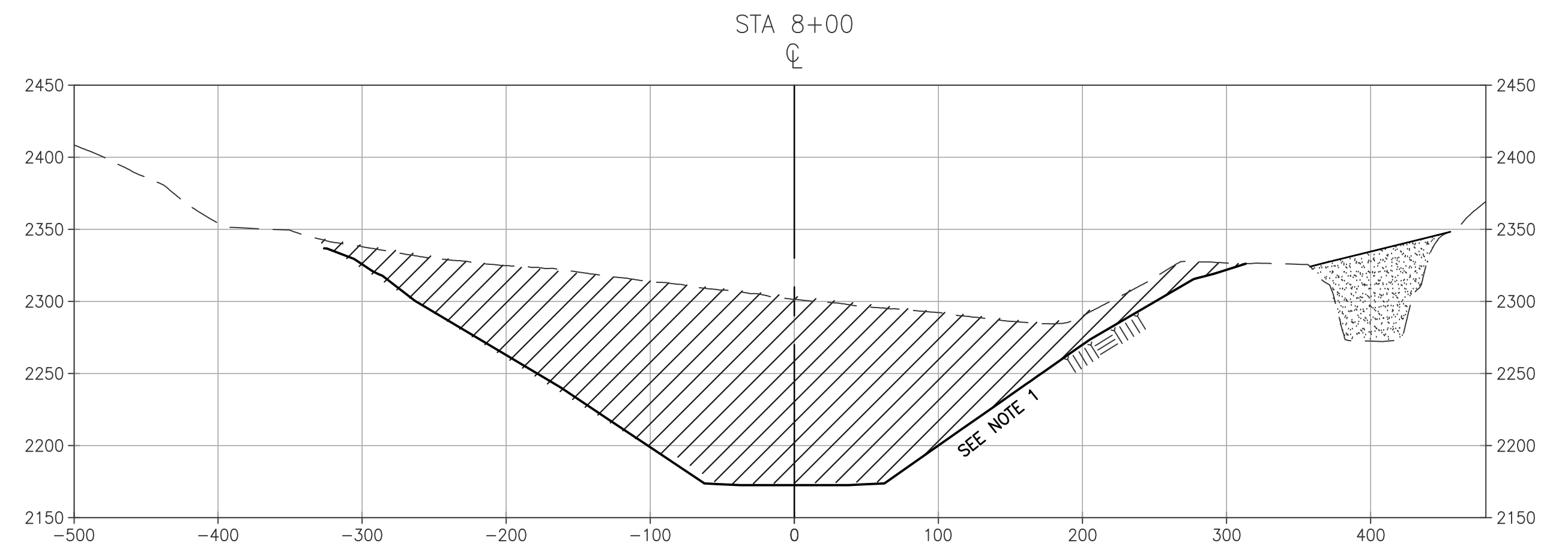
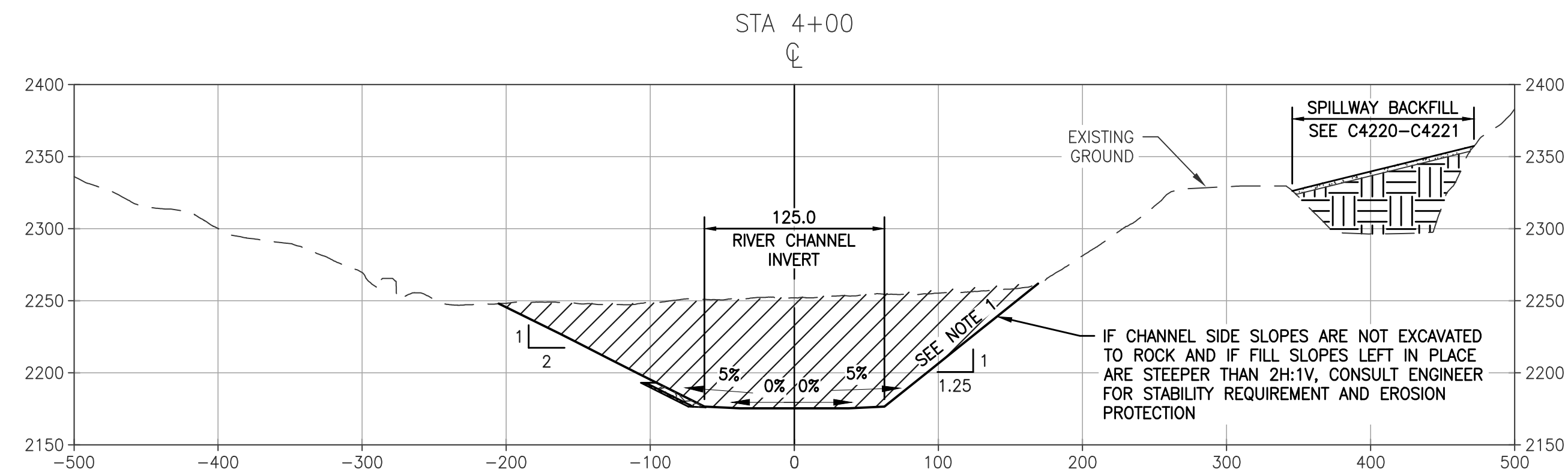

|             |  |        |             |
|-------------|--|--------|-------------|
| PROJECT     | KLAMATH RIVER RENEWAL PROJECT  | PROJ # | VA103-640/1 |
| DATE        | 05/27/2022   | DWG    | C4210       |
| SHEET TITLE | IRON GATE FACILITY<br>EMBANKMENT REMOVAL<br>GRADING GENERAL ARRANGEMENT PLAN |        |             |

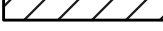
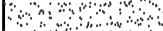
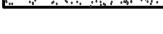



- |   |                           |
|---|---------------------------|
|  | DEMOLITION / REMOVAL      |
|  | GENERAL FILL (E9)         |
|  | RANDOM FILL (E10)         |
|  | CONCRETE RUBBLE (CR1/CR2) |
|  | EROSION PROTECTION (E7b)  |
|  | BEDDING (E8)              |

0 80 160 320

1" = 80'

$$1'' = 80'$$

1. ALL CUT SLOPES STEEPER THAN 2H:1V ARE ASSUMED TO BE IN AN AREA WHERE EXCAVATION WILL BE BEDROCK.
2. ALL CORE ZONE MATERIAL (ZONE III) SHALL BE EXCAVATED TO BEDROCK. ALL OTHER EXCAVATED SURFACE SHALL BE TO BEDROCK OR EXCAVATION EXTENTS SHOWN HERE.
3. ALL FINAL GRADE SURFACES TO BE COVERED AND TREATED ACCORDING TO C4600 DRAWING SERIES.
4. NO EROSION PROTECTION REQUIRED WHERE EXCAVATION IS TO BEDROCK.
5. TOP OF RIPRAP SHALL PROVIDE 3 ft. OF FREEBOARD ON THE 1% PROBABLE WATER SURFACE LEVEL AND SHALL APPROXIMATELY FOLLOW THE CHANNEL SLOPE.

WARNING

0 1/2 1



IF THIS BAR DOES  
NOT MEASURE 1"  
THEN DRAWING IS  
NOT TO SCALE



|           |           |
|-----------|-----------|
| IN CHARGE | N. BISHOP |
|-----------|-----------|



**KLAMATH  
RIVER RENEWAL  
CORPORATION**

|             |   |
|-------------|---|
| SHEET TITLE | <p>IRON GATE FACILITY</p> <p>EMBANKMENT REMOVAL</p> <p>GRADING GENERAL ARRANGEMENT SECTIONS</p> |
|-------------|---|

C4211



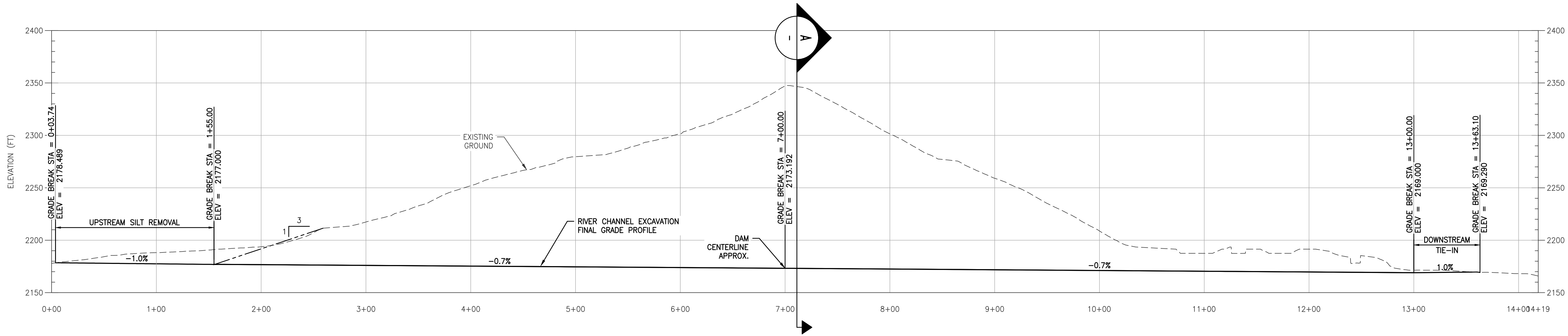

PROFILE  
1" = 50'

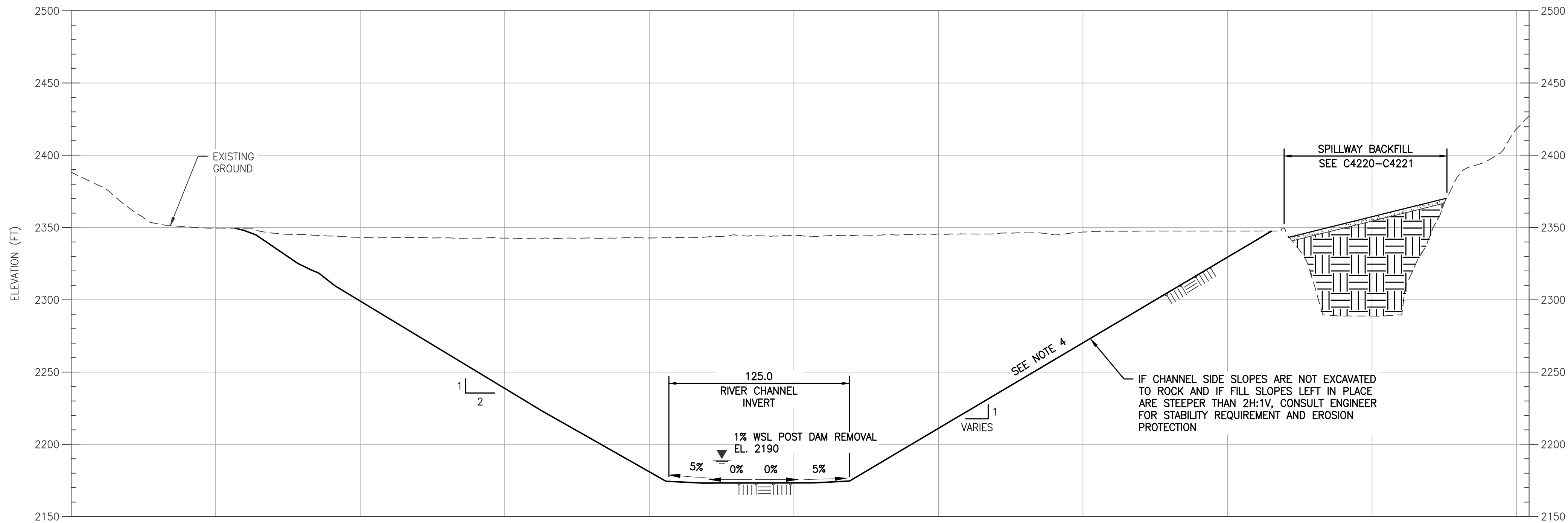

SECTION – FINAL GRADE SECTION AT DAM CENTERLINE  
1" = 50'

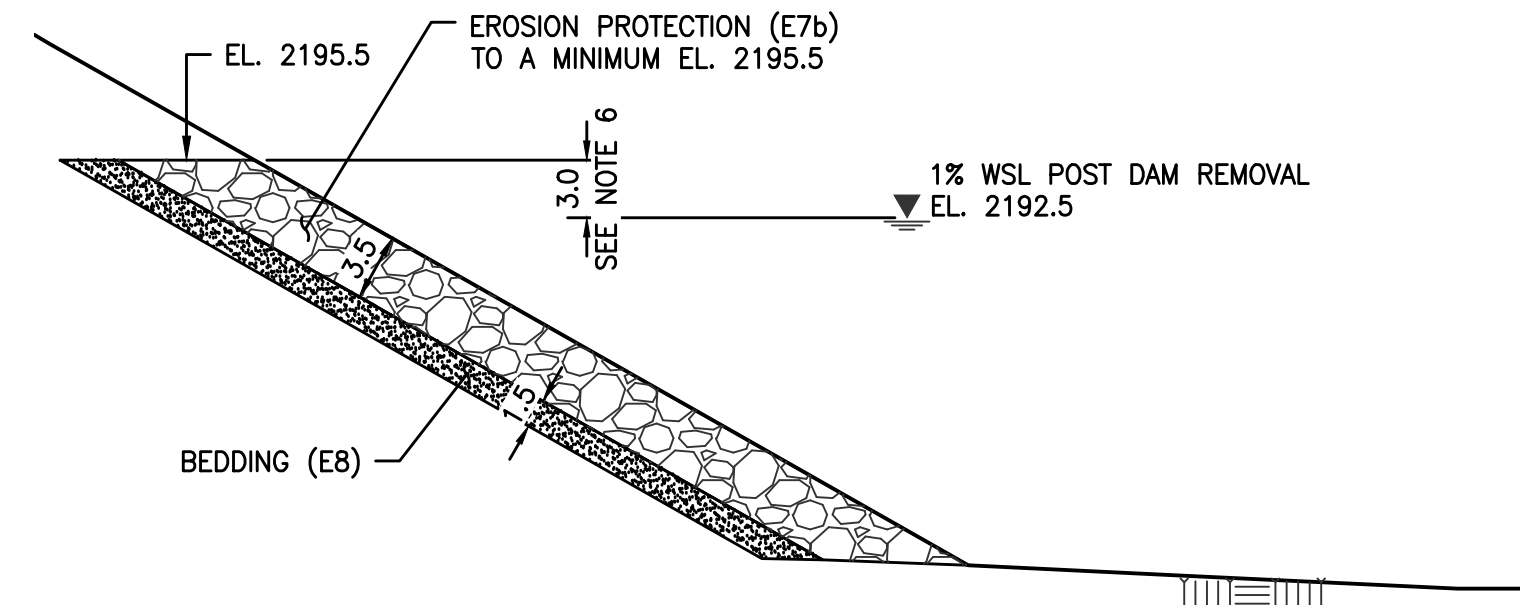

1  
C4211  
DETAIL – TYPICAL DETAIL FOR RIPRAP  
1" = 10'

LEGEND:

- GENERAL FILL (E9)
- RANDOM FILL (E10)
- EROSION PROTECTION (E7b)
- BEDDING (E8)

NOTES:

- ALL CORE ZONE MATERIAL (ZONE III) SHALL BE EXCAVATED TO BEDROCK. ALL OTHER EXCAVATED SURFACE SHALL BE TO BEDROCK OR EXCAVATION EXTENTS SHOWN HERE.
- FOR FINAL GRADE SURFACE TREATMENT, SEE DRAWING SERIES C4600.
- NO EROSION PROTECTION REQUIRED WHERE EXCAVATION IS TO BEDROCK.
- ALL CUT SLOPES STEEPER THAN 2H:1V SHALL BE EXCAVATED TO BEDROCK. EXACT BEDROCK PROFILE UNKNOWN.
- ALL CUT SLOPES SHALLOWER THAN 2H:1V SHALL BE EXCAVATED TO BEDROCK OR THE INDICATED CUT SLOPE IN THE DRAWINGS AT THE CONTRACTOR'S OPTION.
- TOP OF EROSION PROTECTION SHALL PROVIDE A MINIMUM OF 3 ft. OF FREEBOARD ON THE 1% PROBABLE WATER SURFACE LEVEL WHERE RIPRAP DOES NOT GO TO BEDROCK. TOP OF EROSION PROTECTION SHALL APPROXIMATELY FOLLOW THE CHANNEL SLOPE DOWNSTREAM FROM SECTION SHOWN WHERE THE TOP OF EROSION PROTECTION BEGINS AT EL. 2195.5.

ISSUED FOR CONSTRUCTION

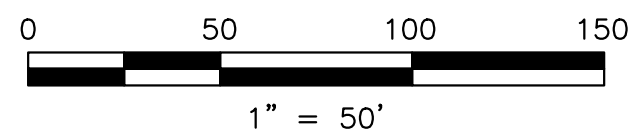

g:\projects\16-01-2023-1417\16-01-2023-1417.dwg  
C:\Users\jyong\OneDrive\Documents\16-01-2023-1417\16-01-2023-1417.dwg

| REV | DESCRIPTION             | BY  | CHK | APP | DATE     |
|-----|-------------------------|-----|-----|-----|----------|
| 1   | ISSUED FOR CONSTRUCTION | KTW | SY  | SRM | 06/22/22 |
| 0   | ISSUED FOR CONSTRUCTION | KTW | SY  | SRM | 05/27/22 |

WARNING  
0 1/2 1  
IF THIS BAR DOES NOT MEASURE 1" THEN DRAWING IS NOT TO SCALE



|           |                  |
|-----------|------------------|
| DESIGNED  | K. WECHSELBERGER |
| DRAWN     | A. TSENG         |
| REVIEWED  | S. YONG          |
| IN CHARGE | N. BISHOP        |
| APPROVED  | S. MOTTRAM       |



|   |  |        |             |
|---|--|--------|-------------|
| PROJECT   |  | PROJ # | VA103-640/1 |
| KLAMATH RIVER RENEWAL PROJECT   |  | DATE   | 05/27/2022  |
| SHEET TITLE   |  | DWG    | C4212       |
| IRON GATE FACILITY<br>EMBANKMENT REMOVAL<br>GRADING CHANNEL PROFILE, SECTION AND DETAIL |  |        |             |



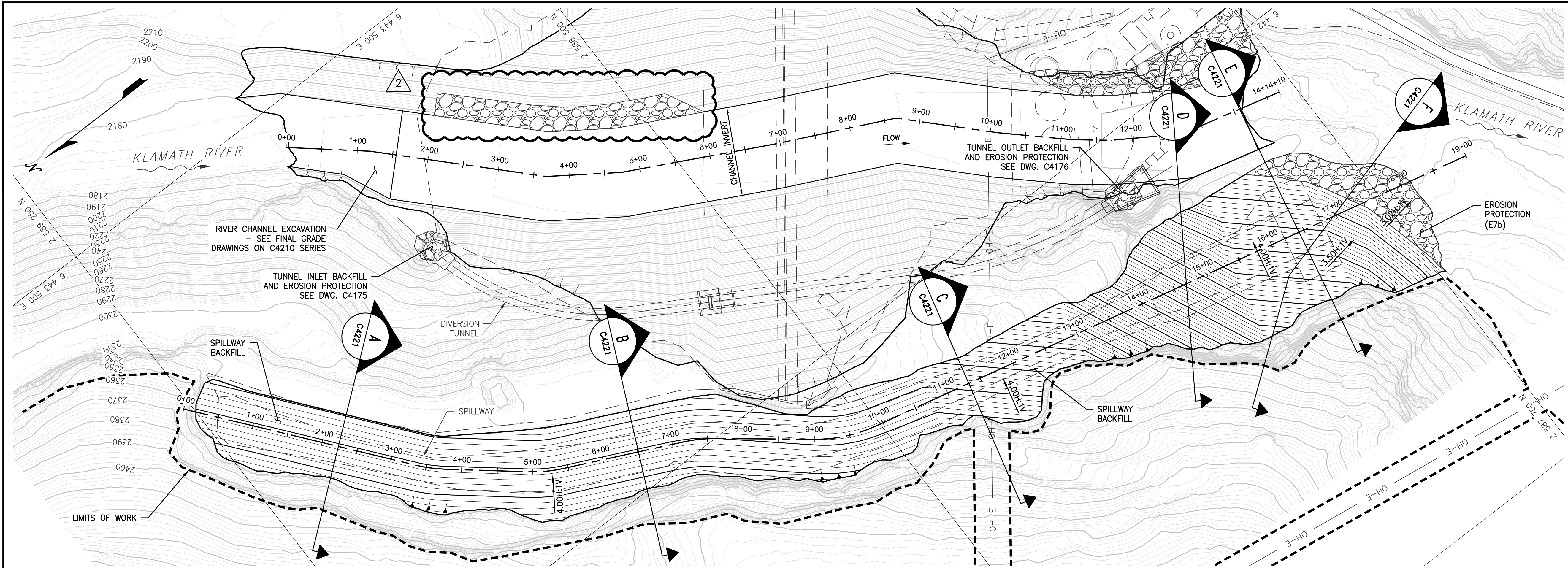

PLAN  
1" = 80'

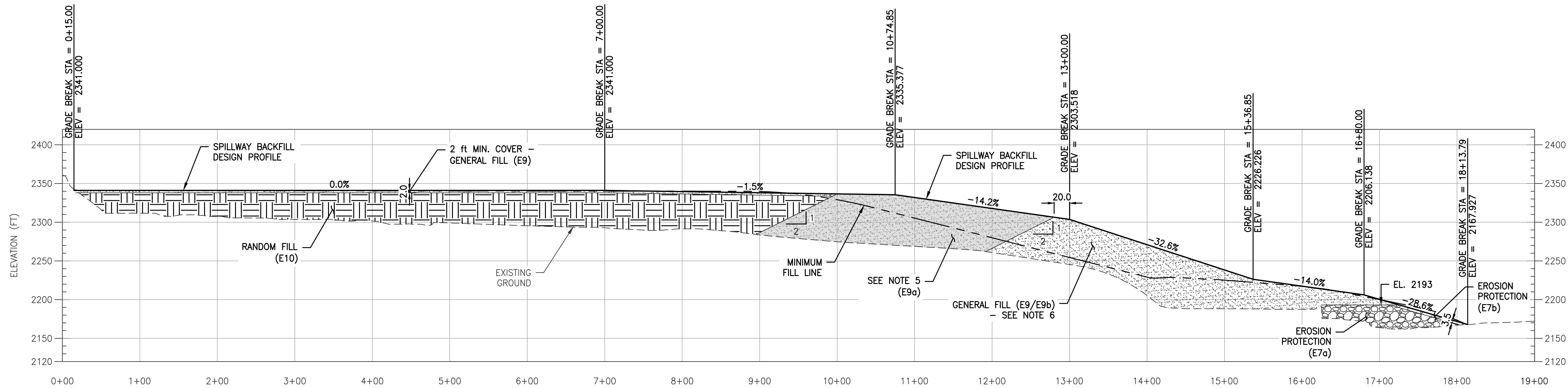

PROFILE  
1" = 80'

NOTES:

1. SPILLWAY INFILL MATERIALS SHALL BE COMPRISED OF REMOVED EMBANKMENT MATERIALS.
2. SPILLWAY INFILL SHALL BE INITIAL EMBANKMENT MATERIAL SPOIL AREA FOR THE UPPER PORTIONS OF THE EMBANKMENT REMOVAL.
3. PLACE EROSION PROTECTION ON DOWNSTREAM TOE OF SPILLWAY FILL ONCE COMPLETE, UPON FINAL GRADING, OR USE RIPRAP REMOVED FROM DOWNSTREAM FACE OF DAM DURING STAGE 1 FOR THE LOWER SPILLWAY LIFTS TO ESTABLISH RIPRAPPED TOE.
4. FOR EROSION AND SEDIMENT CONTROL DETAILS SEE DRAWING SERIES C4215 TO C4219.
5. WHERE E9a IS PLACED IN THE SPILLWAY DISPOSAL SITE, IT SHALL BE PLACED IN ACCORDANCE WITH THE LIFT THICKNESS AND COMPACTION REQUIREMENTS OF E9.
6. OPTION TO UTILIZE GENERAL FILL (E9) OR (E9b) AS COVER MATERIAL. FINAL STABILIZATION TREATMENTS DIFFER AS PER TECHNICAL SPECIFICATION 31 25 00.

LEGEND:

- GENERAL FILL (E9/E9a/E9b)
- RANDOM FILL (E10)
- EROSION PROTECTION (E7a/E7b)

ISSUED FOR CONSTRUCTION

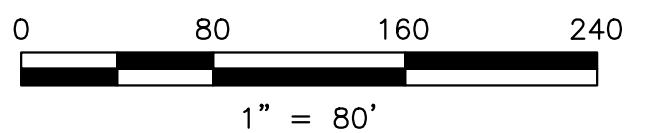

| REV | DESCRIPTION                         | BY  | CHK | APP | DATE     |
|-----|-------------------------------------|-----|-----|-----|----------|
| 2   | EROSION PROTECTION LIMITS CORRECTED | KTW | SY  | SRM | 12/21/22 |
| 1   | ISSUED FOR CONSTRUCTION             | KTW | SY  | SRM | 06/22/22 |
| 0   | ISSUED FOR CONSTRUCTION             | KTW | SY  | SRM | 05/27/22 |

WARNING  
0 1/2 1  
IF THIS BAR DOES NOT MEASURE 1" THEN DRAWING IS NOT TO SCALE

PREPARED BY  
**Knight Piésold CONSULTING**  
**Kiewit**

DESIGNED K. WECHSELBERGER  
DRAWN A. TSENG  
REVIEWED S. YONG  
IN CHARGE N. BISHOP  
APPROVED S. MOTTRAM

PREPARED FOR  
**KLAMATH RIVER RENEWAL CORPORATION**

|   |                       |
|---|-----------------------|
| PROJECT<br><b>KLAMATH RIVER RENEWAL PROJECT</b>   | PROJ.#<br>VA103-640/1 |
| SHEET TITLE<br>IRON GATE FACILITY<br>EMBANKMENT AND SPILLWAY<br>SPILLWAY INFILL - FINAL GRADE AND PROFILE | DATE<br>05/27/2022    |
|   | DWG<br><b>C4220</b>   |



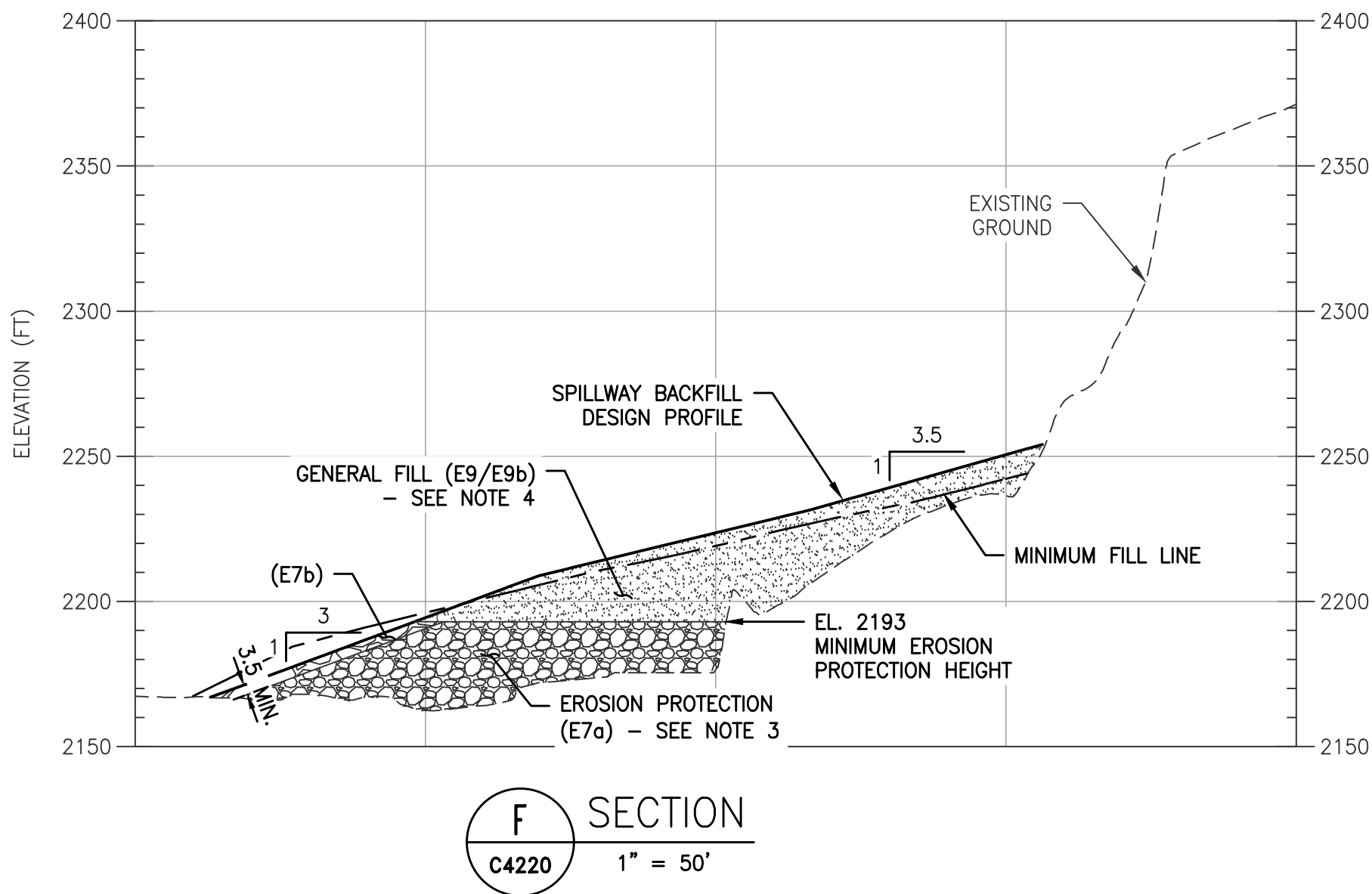
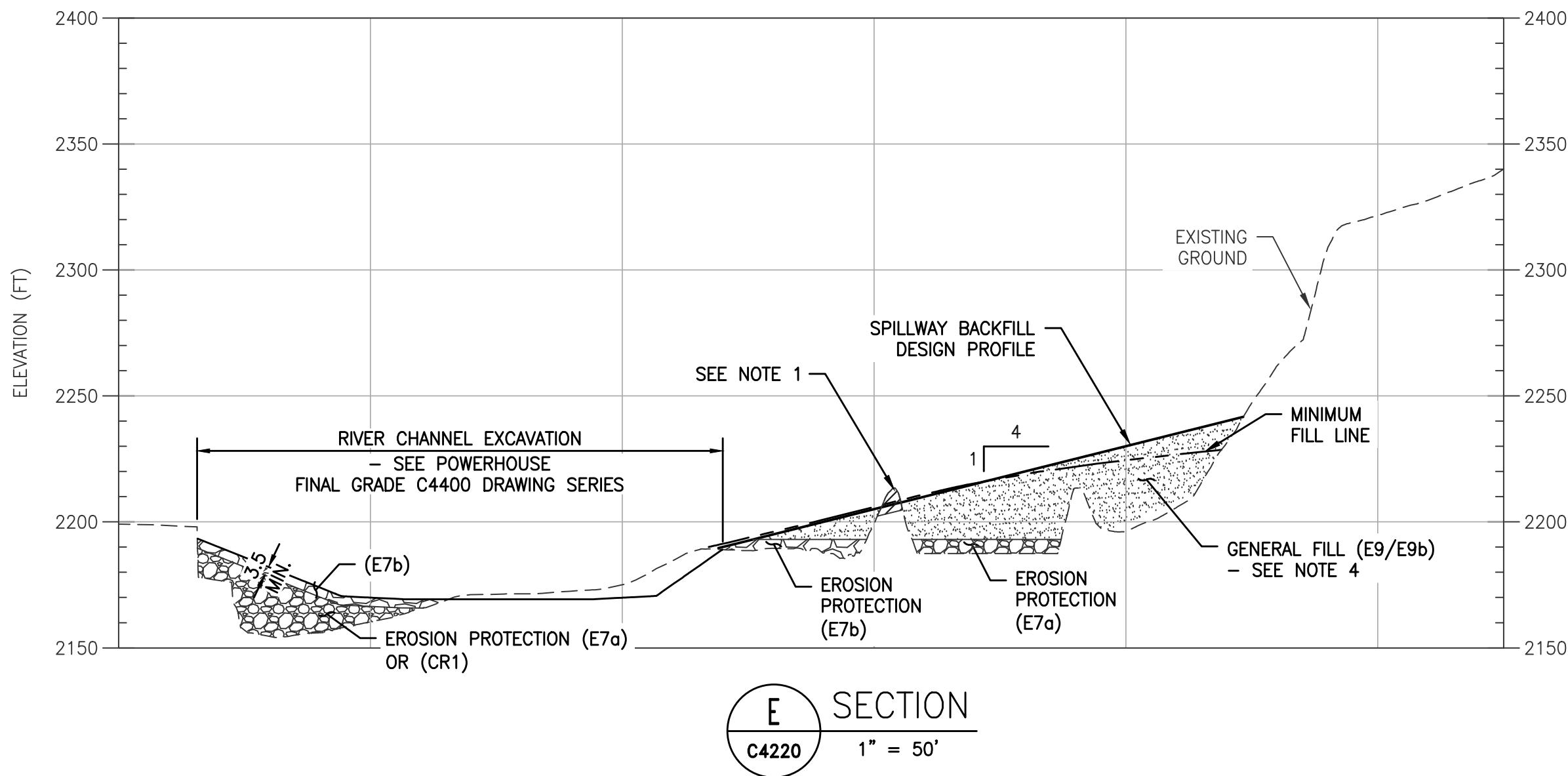
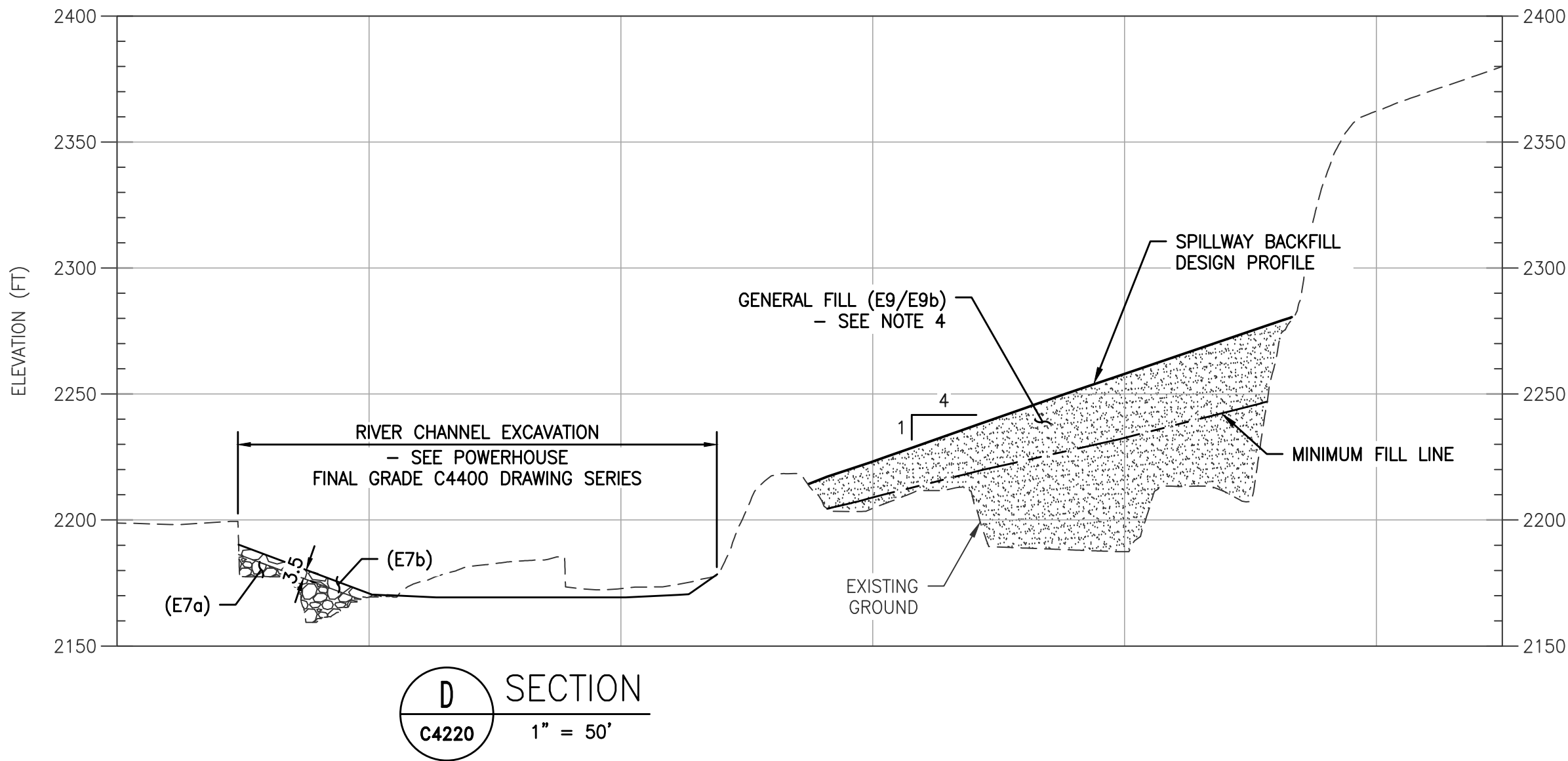
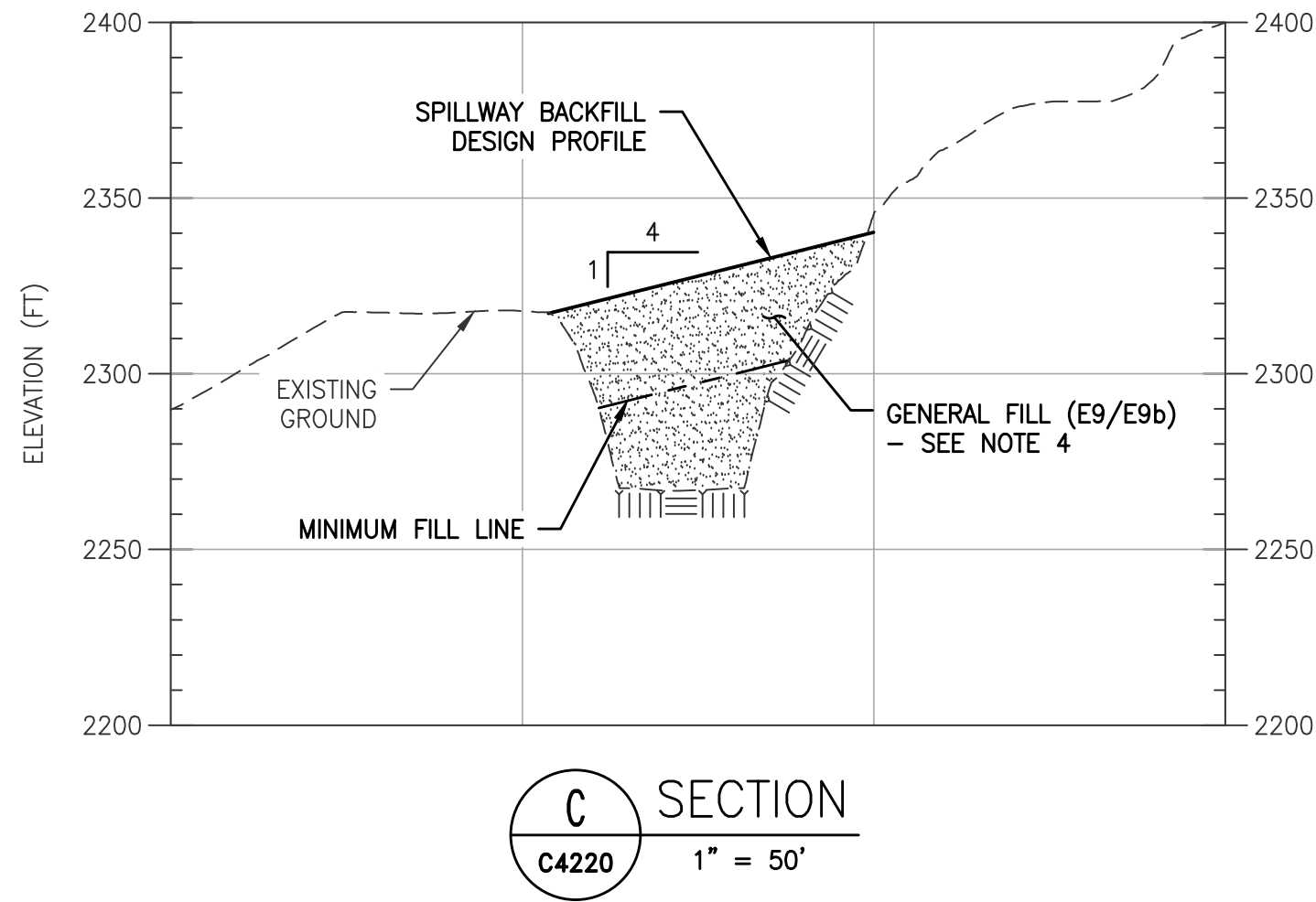
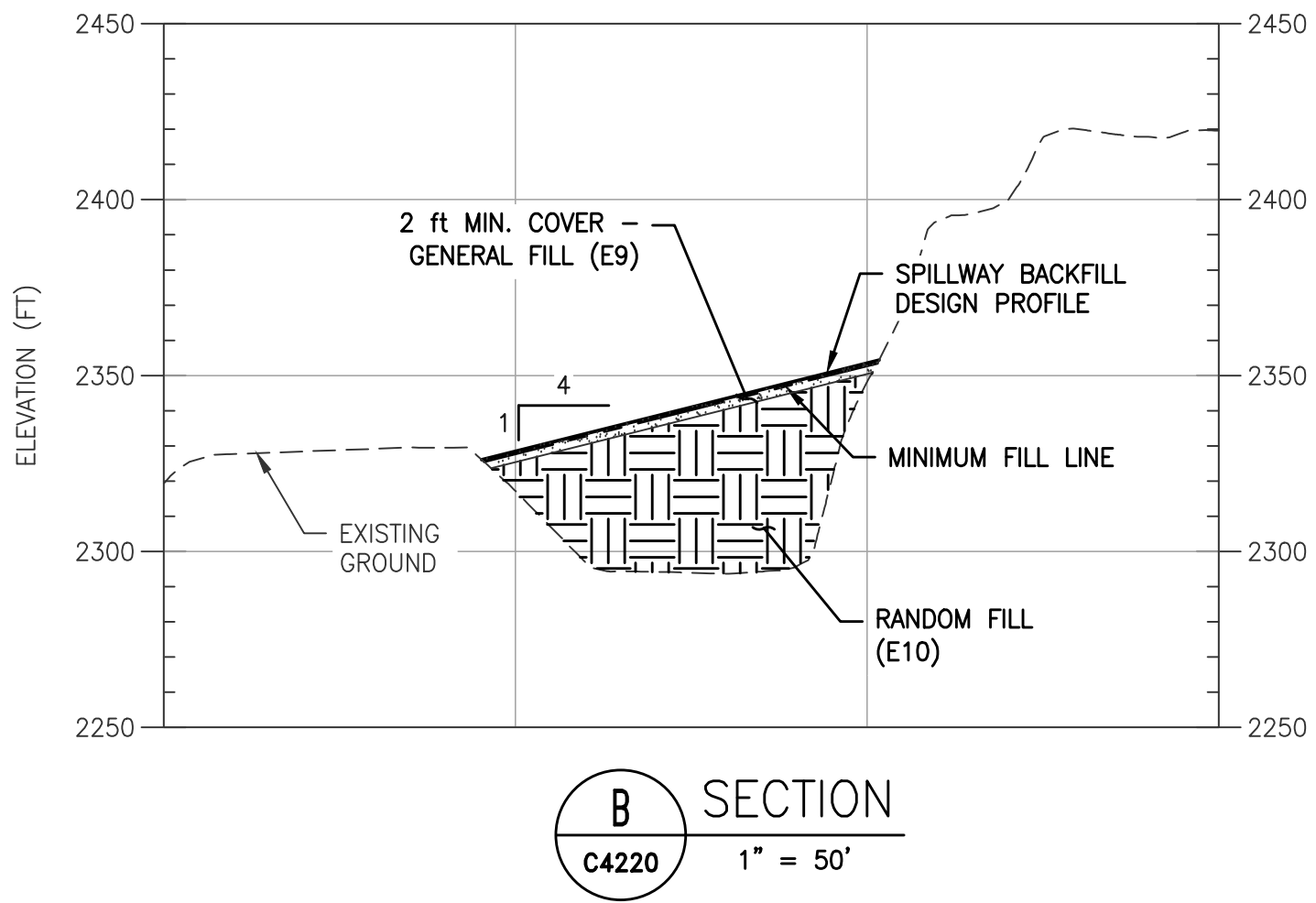
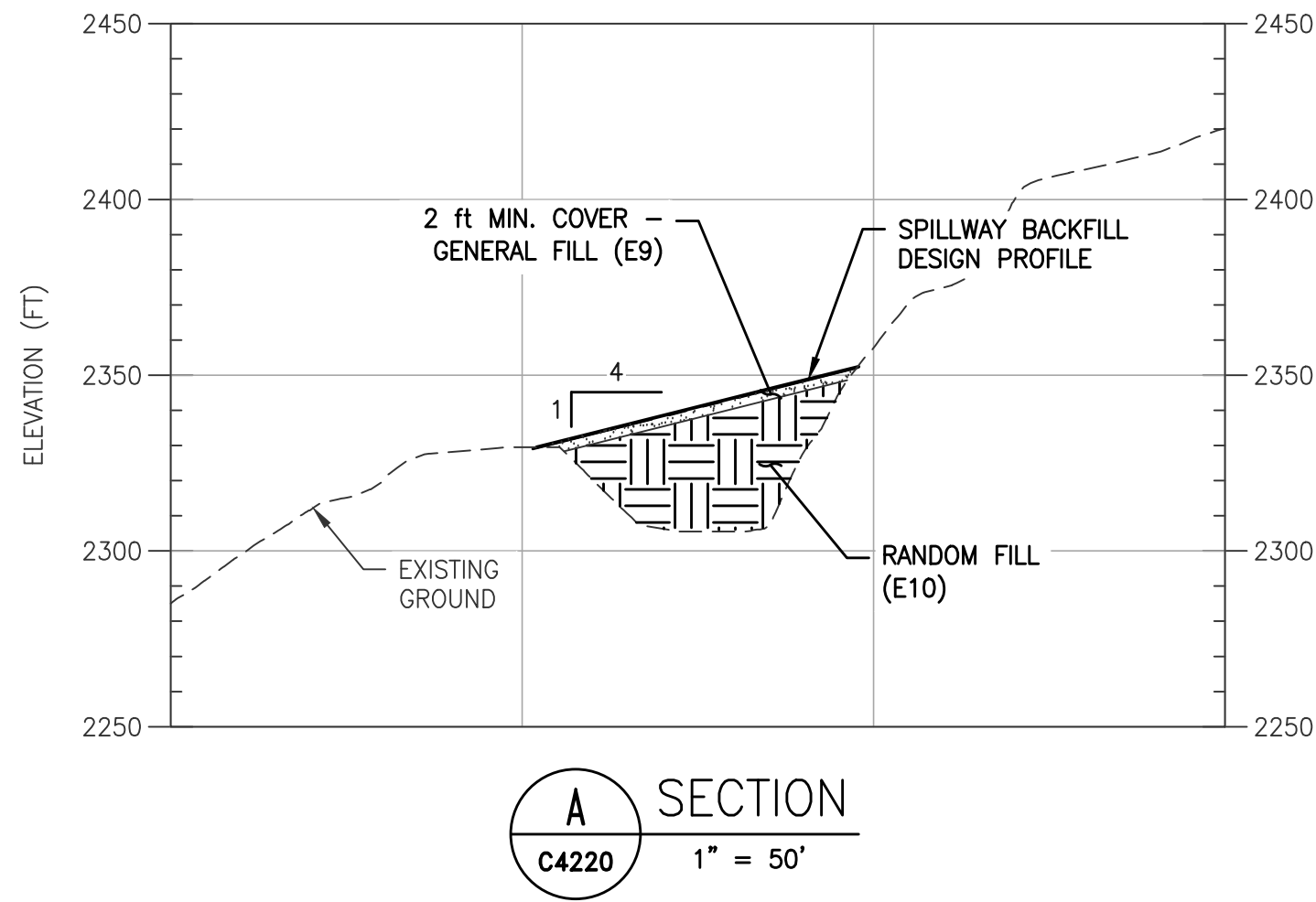

NOTES:

1. REMOVE PORTION OF CONCRETE SPILLWAY CHUTE AS NEEDED TO BE AT MINIMUM 2 ft BELOW PROPOSED GRADE.
2. SALVAGED EROSION PROTECTION FROM THE DOWNSTREAM FACE OF THE DAM.
3. WHERE ABOVE THE WATER LINE AT THE TIME OF PLACEMENT, E7a CAN BE REPLACED WITH E9, GENERAL FILL, AND PROTECTED WITH E8, BEDDING AND E7b, EROSION PROTECTION, CONSISTING WITH THE TYPICAL DETAIL SHOWN ON C4212.
4. OPTION TO UTILIZE GENERAL FILL (E9) OR (E9b) AS COVER MATERIAL. FINAL STABILIZATION TREATMENTS DIFFER AS PER TECHNICAL SPECIFICATION 31 25 00.

LEGEND:

- GENERAL FILL (E9/E9b)
- RANDOM FILL (E10)
- EROSION PROTECTION (E7b)
- DEMOLITION / REMOVAL

ISSUED FOR CONSTRUCTION

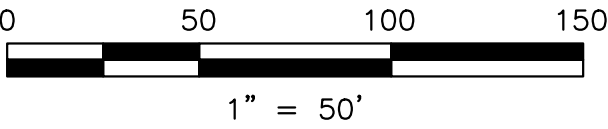

g:\projects\16-71\_2022\_4135m\16-71\_2022\_4135m.dwg 05/27/2022 11:11:11 AM C:\Users\KYLE\OneDrive\Documents\C4221\C4221.dwg

| REV | DESCRIPTION             | BY  | CHK | APP | DATE     |
|-----|-------------------------|-----|-----|-----|----------|
| 1   | ISSUED FOR CONSTRUCTION | KTW | SY  | SRM | 06/22/22 |
| 0   | ISSUED FOR CONSTRUCTION | KTW | SY  | SRM | 05/27/22 |

WARNING  
0 1/2 1  
IF THIS BAR DOES NOT MEASURE 1" THEN DRAWING IS NOT TO SCALE



|           |                  |
|-----------|------------------|
| DESIGNED  | K. WECHSELBERGER |
| DRAWN     | A. TSENG         |
| REVIEWED  | S. YONG          |
| IN CHARGE | N. BISHOP        |
| APPROVED  | S. MOTTRAM       |



|             |   |       |
|-------------|---|-------|
| PROJECT     | KLAMATH RIVER RENEWAL PROJECT   |       |
| SHEET TITLE | IRON GATE FACILITY<br>EMBANKMENT AND SPILLWAY<br>SPILLWAY INFILL - FINAL GRADE SECTIONS |       |
| PROJ #      | VA103-640/1   | DATE  |
| 05/27/2022  | DWG   | C4221 |



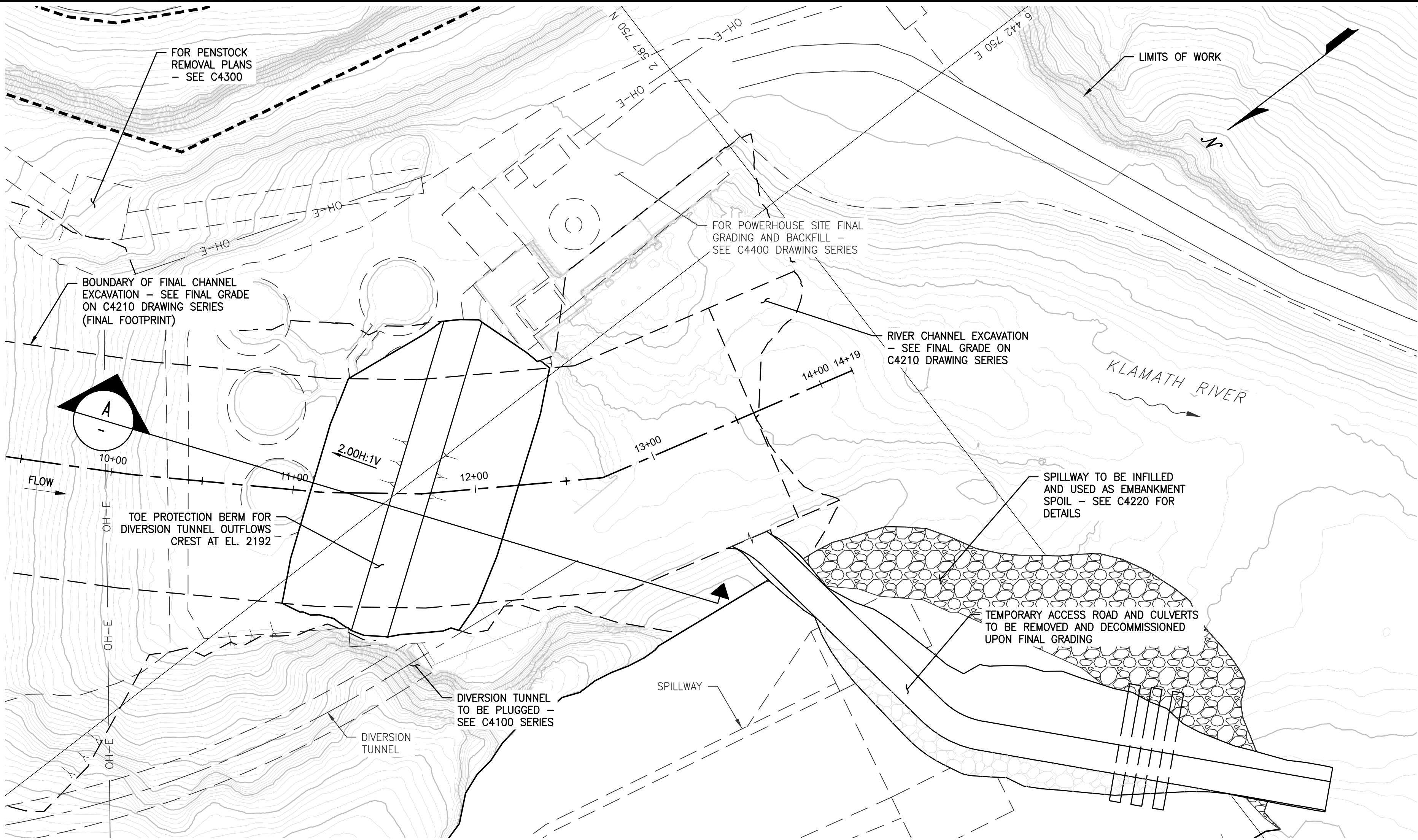

POWERHOUSE SITE PLAN - SEQUENCE 1

1" = 40'

NOTES:

1. REMOVE REMAINING THREE FISH HOLDING FACILITIES.
2. POWERHOUSE TO BE DEMOLISHED AND BACKFILLED SEE DRAWINGS C4401 TO C4403 FOR FINAL GRADE AND DEMO LIMITS.
3. REMOVE ANY REMAINING FISH LADDER CONCRETE NOT REMOVED PRIOR TO DRAWDOWN.
4. TOE PROTECTION BERM TO BE COMPRISED OF NATIVE MATERIALS, ONCE EXCAVATION IS COMPLETE MATERIAL SHALL BE ASSESSED FOR WATER RETAINING PROPERTIES. CORE ZONE MATERIAL TO BE SALVAGED AND USED AS NECESSARY TO PROTECT EMBANKMENT EXCAVATION FROM BACKWATERING TAILRACE FLOWS.

LEGEND:

- (E) EARTHFILL
- EROSION PROTECTION (E7b)
- DEMOLITION / REMOVAL

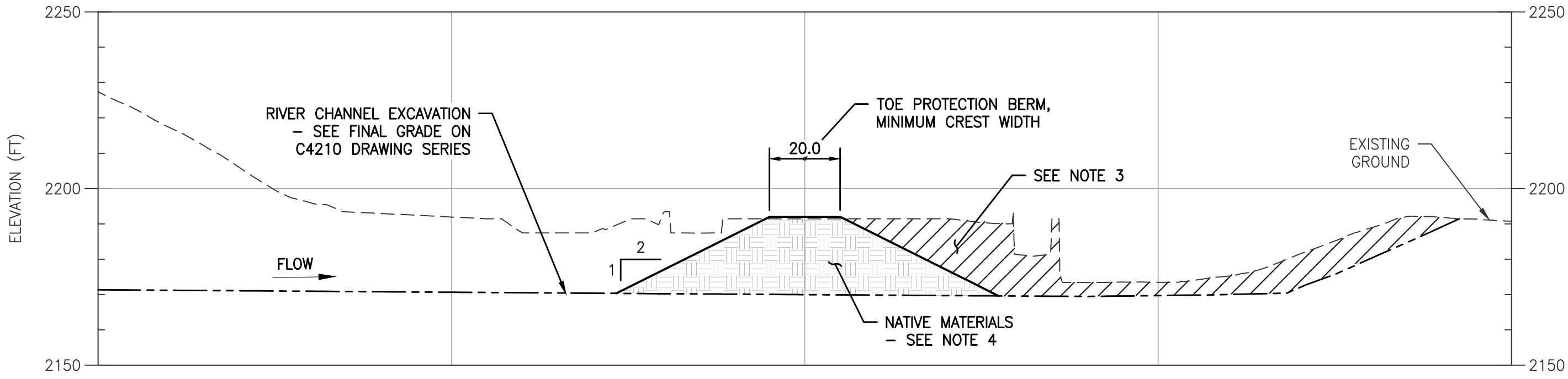

SECTION A  
1" = 30'

ISSUED FOR CONSTRUCTION

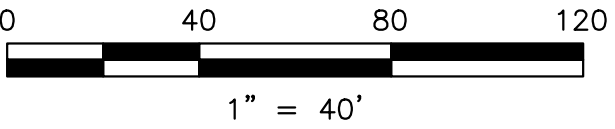

g:\projects\1000\1000.dwg  
05/27/2022 10:51:00 AM  
C:\Users\KYLE\OneDrive\Documents\Klamath River Renewal\1000\1000.dwg

| REV | DESCRIPTION             | BY  | CHK | APP | DATE     |
|-----|-------------------------|-----|-----|-----|----------|
| 0   | ISSUED FOR CONSTRUCTION | KTW | SY  | SRM | 05/27/22 |



|           |                  |
|-----------|------------------|
| DESIGNED  | K. WECHSELBERGER |
| DRAWN     | A. TSENG         |
| REVIEWED  | S. YONG          |
| IN CHARGE | N. BISHOP        |
| APPROVED  | S. MOTTRAM       |



|             |  |  |
|-------------|--|--|
| PROJECT     | KLAMATH RIVER RENEWAL PROJECT  |  |
| PROJ #      | VA103-640/1  |  |
| DATE        | 05/27/2022   |  |
| SHEET TITLE | IRON GATE FACILITY<br>POWERHOUSE AND FISH FACILITIES<br>REMOVAL AND GRADING - (SHEET 1 OF 2) |  |
| DWG         | C4400  |  |



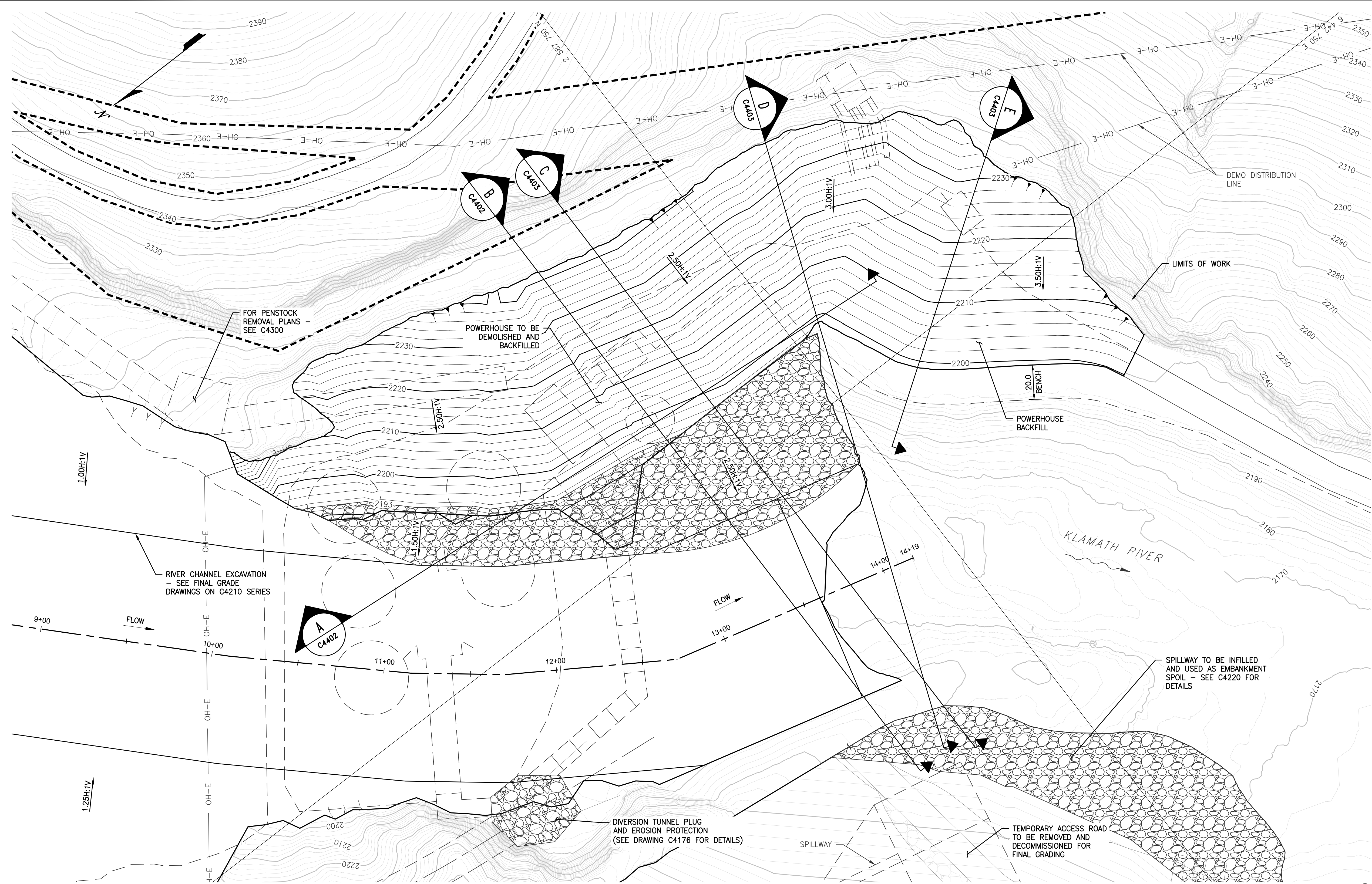

NOTES:

1. REMOVE ALL MECHANICAL AND ELECTRICAL EQUIPMENT PRIOR TO BACKFILL OF POWERHOUSE AND TAILRACE, WITH THE EXCEPTION OF EMBEDDED STEEL WHICH MAY BE BURIED IN PLACE.
2. ALL OIL AND WATER SUPPLY LINES TO BE FLUSHED PRIOR TO BACKFILL.
3. POWERHOUSE SITE INFILL AND SPOIL SHALL BE COMPRISED OF REMOVED EMBANKMENT MATERIALS (E9) OR CONCRETE RUBBLE (CR1).
4. ALL FILL SHALL BE CAPPED WITH A MINIMUM OF 3 ft OF COVER MATERIAL CONSISTENT WITH C4600 DRAWING SERIES.
5. EROSION PROTECTION SHALL PROVIDE A MINIMUM OF 3 ft. OF FREEBOARD OVER THE 1% PROBABLE WATER SURFACE LEVEL BEGINNING AT A MINIMUM ELEVATION OF 2193 ft. AND SHALL APPROXIMATELY FOLLOW THE CHANNEL SLOPE DOWNSTREAM.

LEGEND:

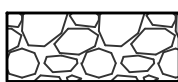

EROSION PROTECTION (E7b)

ISSUED FOR CONSTRUCTION

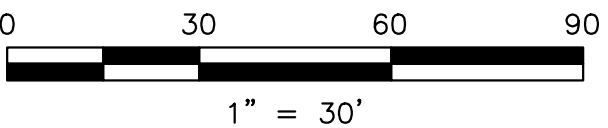

g:\projects\16-21-2022\16-21-2022.dwg  
C:\Users\jdoyle\OneDrive\Documents\16-21-2022\16-21-2022.dwg  
C:\Users\jdoyle\OneDrive\Documents\16-21-2022\16-21-2022.dwg

| REV | DESCRIPTION             | BY  | CHK | APP | DATE     |
|-----|-------------------------|-----|-----|-----|----------|
| 1   | ISSUED FOR CONSTRUCTION | KTW | SY  | SRM | 06/22/22 |
| 0   | ISSUED FOR CONSTRUCTION | KTW | SY  | SRM | 05/27/22 |

WARNING  
0 1/2 1  
IF THIS BAR DOES NOT MEASURE 1" THEN DRAWING IS NOT TO SCALE



|           |                  |
|-----------|------------------|
| DESIGNED  | K. WECHSELBERGER |
| DRAWN     | A. TSENG         |
| REVIEWED  | S. YONG          |
| IN CHARGE | N. BISHOP        |
| APPROVED  | S. MOTTRAM       |



|             |  |
|-------------|--|
| PROJECT     | KLAMATH RIVER RENEWAL PROJECT  |
| SHEET TITLE | IRON GATE FACILITY<br>POWERHOUSE AND FISH FACILITIES<br>REMOVAL AND GRADING - (SHEET 2 OF 2) |

|        |             |
|--------|-------------|
| PROJ # | VA103-640/1 |
| DATE   | 05/27/2022  |
| DWG    | C4401       |

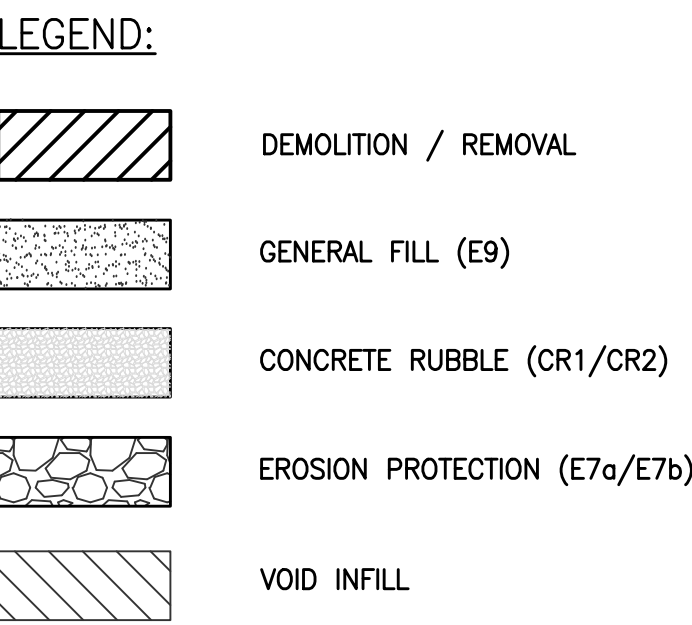
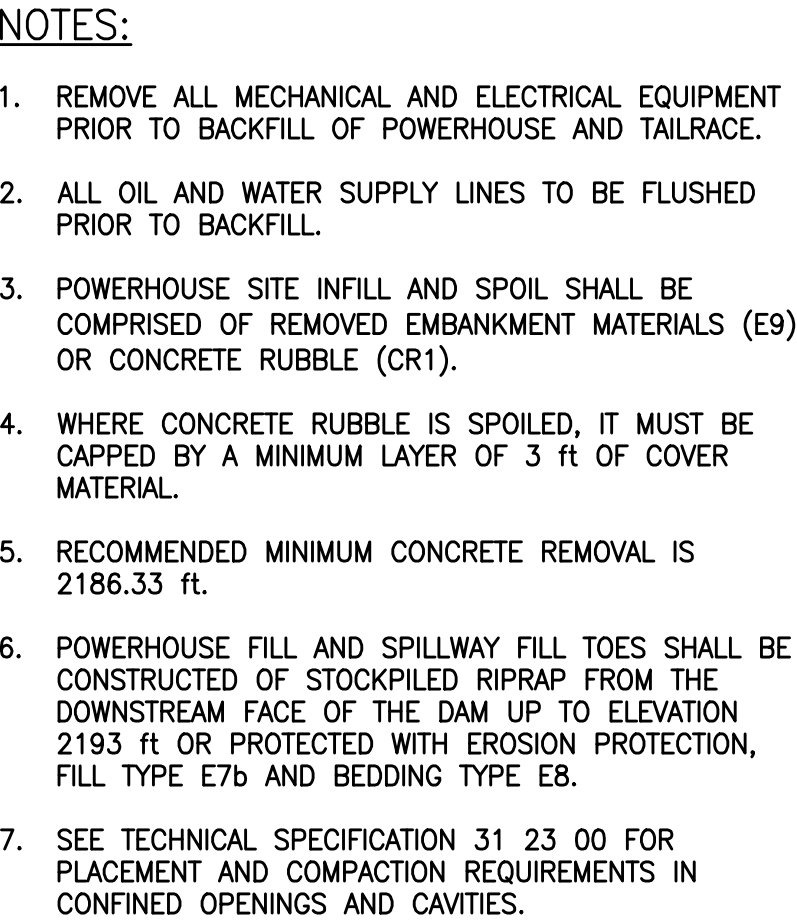

[illegible]



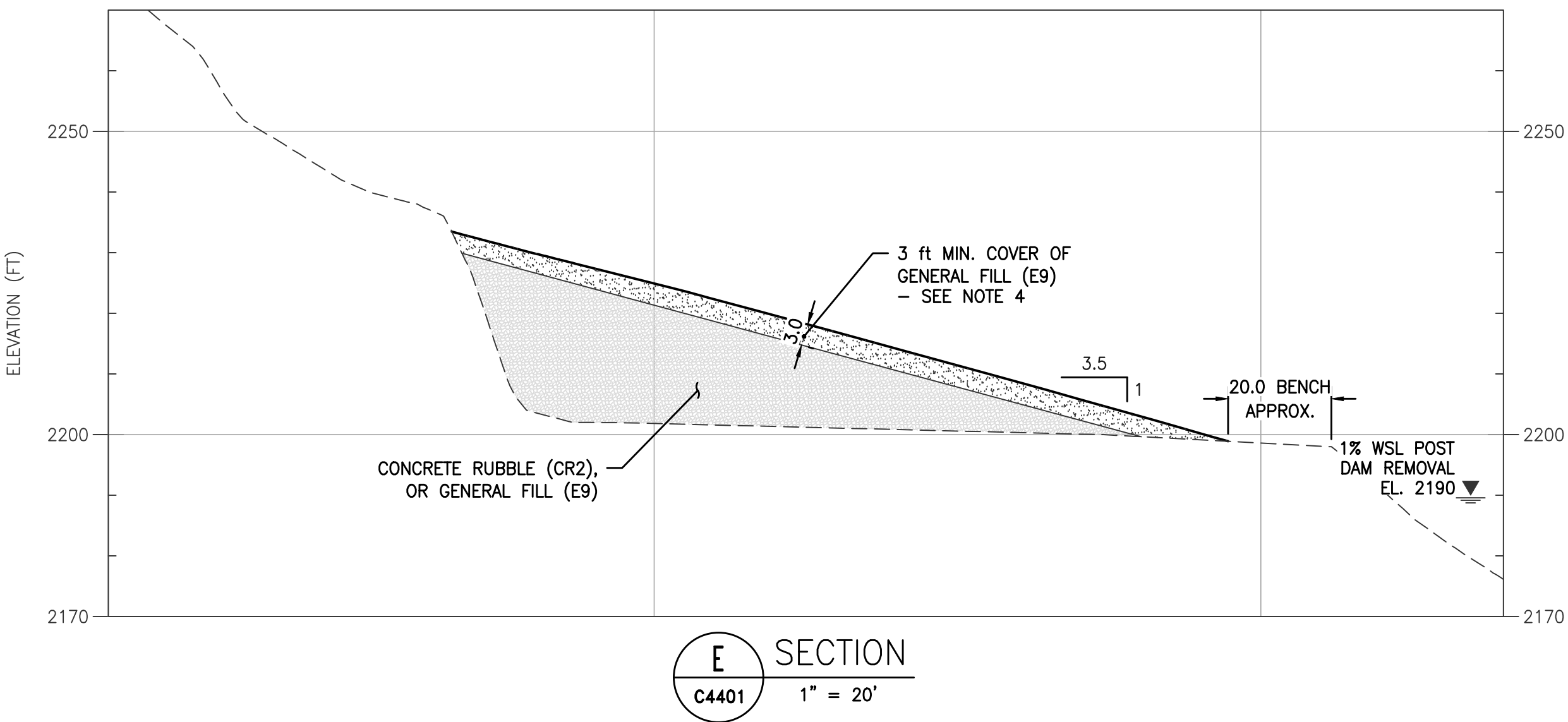
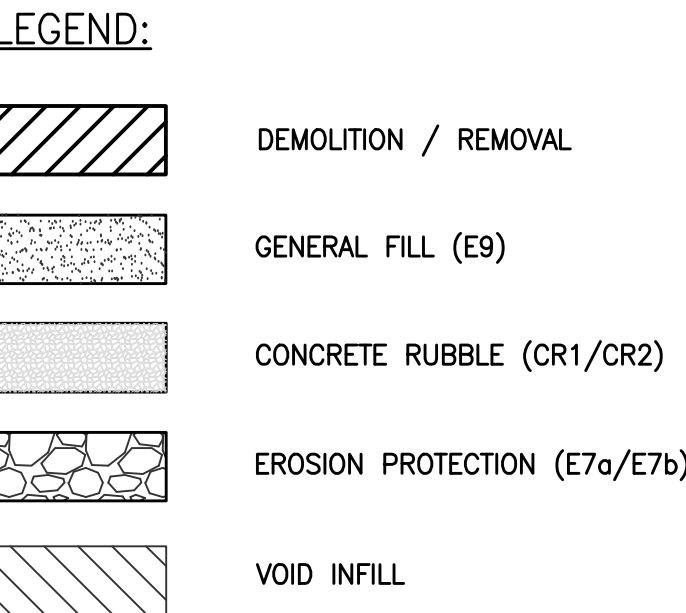
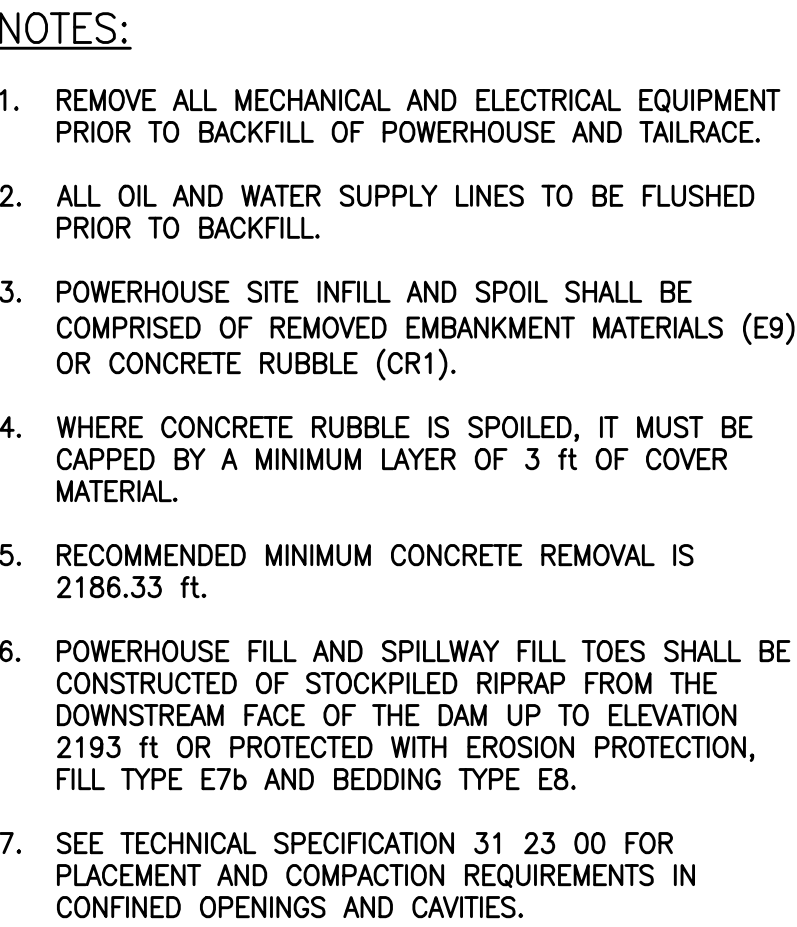

# ISSUED FOR CONSTRUCTION

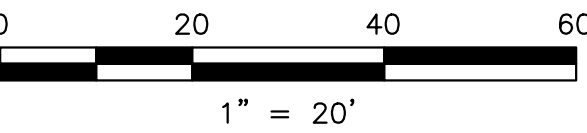

|     |                         |  |  |  |  |     |     |             |  |      |  |  |
|-----|-------------------------|--|--|--|--|-----|-----|-------------|--|------|--|--|
|     |                         |  |  |  |  |     |     |             |  |      |  |  |
|     |                         |  |  |  |  |     |     |             |  |      |  |  |
|     |                         |  |  |  |  |     |     |             |  |      |  |  |
| 1   | ISSUED FOR CONSTRUCTION |  |  |  |  | KTW | SY  | SRM06/22/22 |  |      |  |  |
| 0   | ISSUED FOR CONSTRUCTION |  |  |  |  | KTW | SY  | SRM05/27/22 |  |      |  |  |
| REV | DESCRIPTION             |  |  |  |  | BY  | CHK | APP         |  | DATE |  |  |

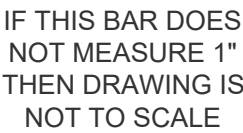

**Knight Piésold**  
CONSULTING



|           |                  |
|-----------|------------------|
| DESIGNED  | K. WECHSELBERGER |
| DRAWN     | A. TSENG         |
| REVIEWED  | S. YONG          |
| IN CHARGE | N. BISHOP        |
| APPROVED  | S. MOTTRAM       |



|                                      |  |   |             |
|--------------------------------------|--|---|-------------|
| PROJECT                              |  | PROJ #  | VA103-640/1 |
| <b>KLAMATH RIVER RENEWAL PROJECT</b> |  | DATE  | 05/27/2022  |
|                                      |  | DWG<br><b>C4403</b>   |             |
| SHEET TITLE                          |  | IRON GATE FACILITY<br>POWERHOUSE AND FISH FACILITIES<br>FINAL GRADE SECTIONS - (SHEET 2 OF 2) |             |



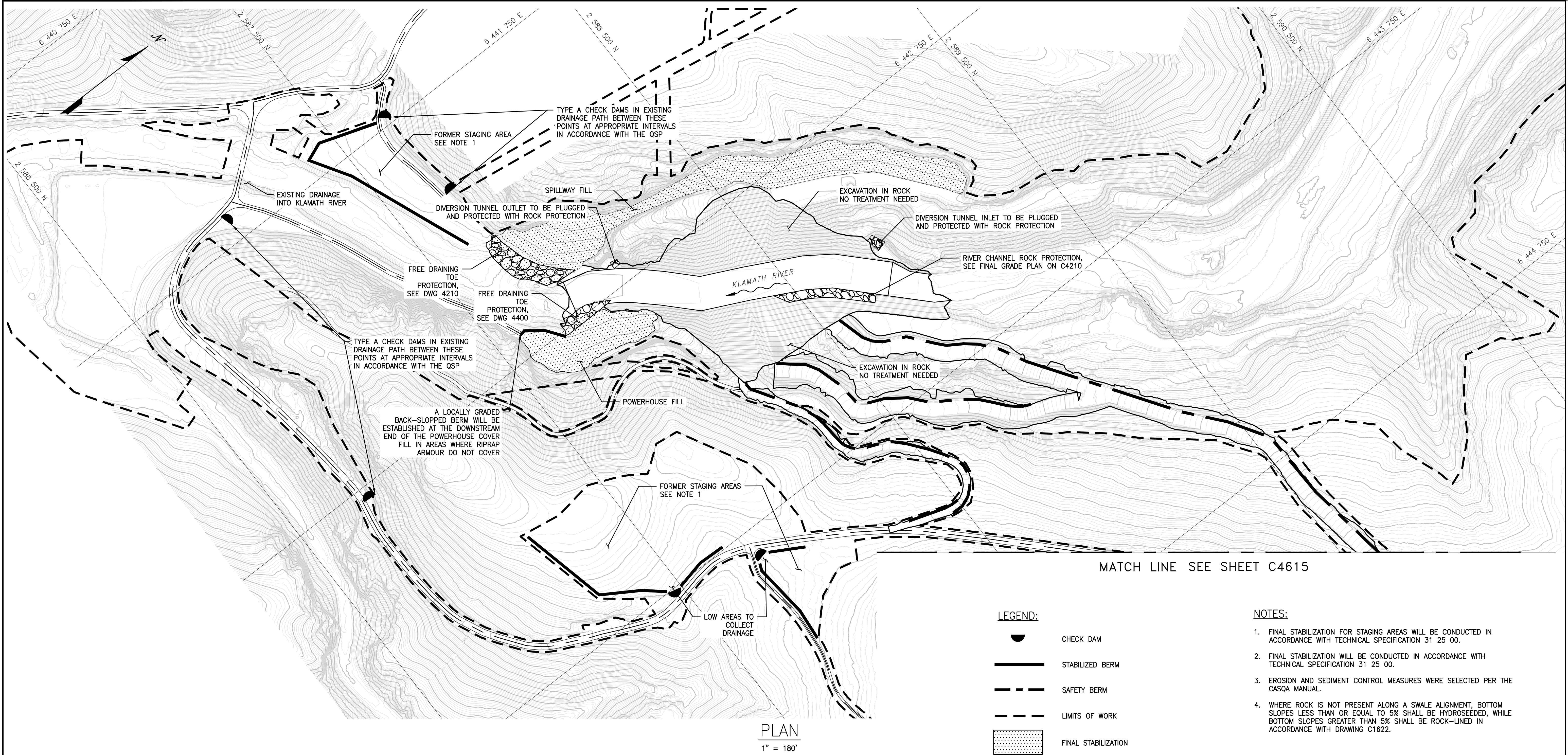

**LEGEND:**

- CHECK DAM
- STABILIZED BERM
- SAFETY BERM
- LIMITS OF WORK
- FINAL STABILIZATION

- NOTES:**
1. FINAL STABILIZATION FOR STAGING AREAS WILL BE CONDUCTED IN ACCORDANCE WITH TECHNICAL SPECIFICATION 31 25 00.
  2. FINAL STABILIZATION WILL BE CONDUCTED IN ACCORDANCE WITH TECHNICAL SPECIFICATION 31 25 00.
  3. EROSION AND SEDIMENT CONTROL MEASURES WERE SELECTED PER THE CASQA MANUAL.
  4. WHERE ROCK IS NOT PRESENT ALONG A SWALE ALIGNMENT, BOTTOM SLOPES LESS THAN OR EQUAL TO 5% SHALL BE HYDROSEEDDED, WHILE BOTTOM SLOPES GREATER THAN 5% SHALL BE ROCK-LINED IN ACCORDANCE WITH DRAWING C1622.

ISSUED FOR CONSTRUCTION

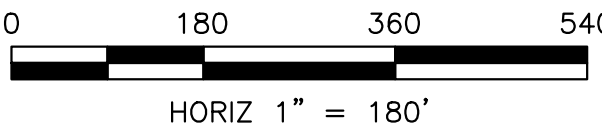

g:\projects\16-102-2022-11727.dwg  
05/26/2022 11:54:00 AM  
C:\Users\jmartin\OneDrive\Documents\Klamath River\DWG\C4610.dwg

|     |                         |    |     |     |          |
|-----|-------------------------|----|-----|-----|----------|
|     |                         |    |     |     |          |
|     |                         |    |     |     |          |
| 1   | ISSUED FOR CONSTRUCTION | LB | SB  | SRM | 06/02/22 |
| 0   | ISSUED FOR CONSTRUCTION | LB | SB  | SRM | 05/27/22 |
| REV | DESCRIPTION             | BY | CHK | APP | DATE     |

**WARNING**  
0 1/2 1  
  
IF THIS BAR DOES NOT MEASURE 1" THEN DRAWING IS NOT TO SCALE



PREPARED BY  
 **Knight Piésold CONSULTING**  
 **Kiewit**

|           |               |
|-----------|---------------|
| DESIGNED  | L. BUETIKOFER |
| DRAWN     | R. MARTIN     |
| REVIEWED  | S. BERKEBILE  |
| IN CHARGE | N. BISHOP     |
| APPROVED  | S. MOTTRAM    |

PREPARED FOR  
 **KLAMATH RIVER RENEWAL CORPORATION**

|             |  |
|-------------|--|
| PROJECT     | <b>KLAMATH RIVER RENEWAL PROJECT</b>   |
| SHEET TITLE | IRON GATE FACILITY<br>FINAL EROSION AND SEDIMENT CONTROL<br>DISPOSAL SITES STABILIZATION PLAN - (SHEET 1 OF 2) |

|        |              |
|--------|--------------|
| PROJ # | VA103-640/1  |
| DATE   | 05/27/2022   |
| DWG    | <b>C4610</b> |